

Glass Cut

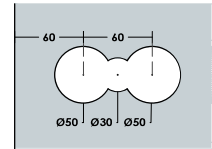

**PCA-DL04**  
**Door Lock**

10mm | Glass Thickness  
Aluminium | Material  
Natural Anodize, Satin, Black Anodize | Finish



**PCA-DL04B**  
**Door Lock Counter Plate**

10mm | Glass Thickness  
Aluminium | Material  
Natural Anodize, Satin, Black Anodize | Finish

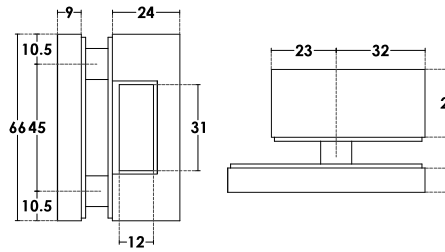

Glass Cut

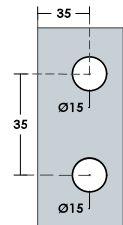

CNC machinery required

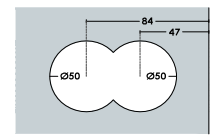
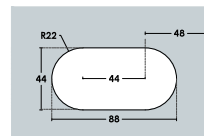

**PCA-DL07A**  
**Door Lock**

10mm | Glass Thickness  
Aluminium | Material  
Natural Anodize, Satin | Finish

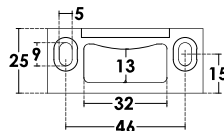
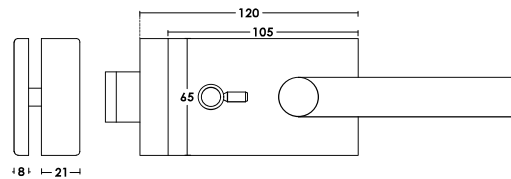

**PCA-DL09A**  
**DL04 Strike Plate**

Aluminium | Material  
Natural Anodize, Satin, Black Anodize | Finish



NEW



**GT14-BL Bolt**



PRODUCT LIST

**6mm glass**  
S35 polycarbonate

**8mm glass**  
No polycarbonate

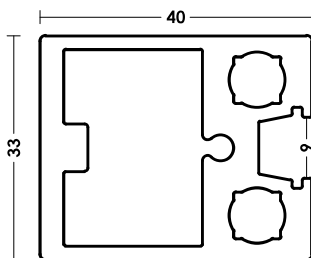
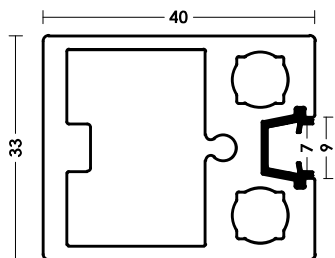

**PCA-GT14-2**  
**GT14 frame for double door**  
1,490 | Weight/meter  
350 cm | Length  
6-8 mm | Glass Thickness  
Aluminium | Material  
Natural Anodize, Satin, Black Anodize | Finish



**PCA-LH01**  
Aluminium | Material  
Natural Anodize, Satin, Black Anodize | Finish

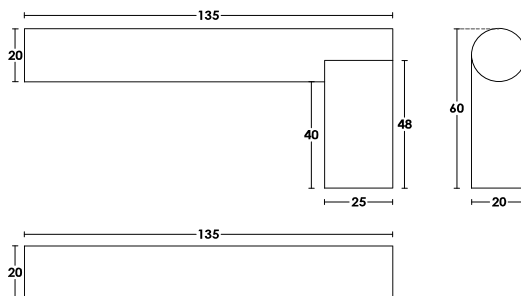

NEW

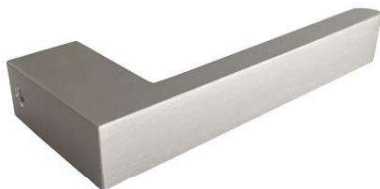

**PCA-LH02**  
Aluminium | Material  
Natural Anodize, Satin, Black Anodize | Finish

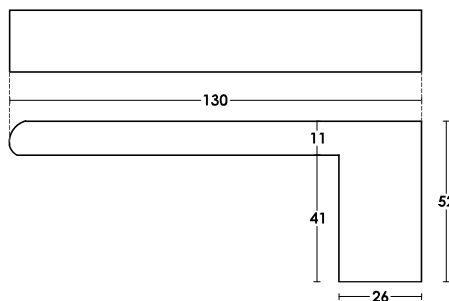

NEW

The handles are suitable on **GT14DL2, GT24DL, GT24DL2, GT24DL3** and **DL04** door locks.

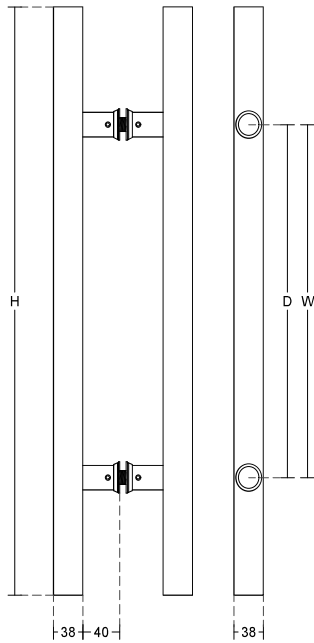
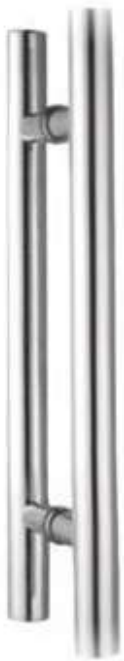

**PCA-HD01**  
**Door Handle Ø38mm**  
 10 mm | Glass Thickness  
 Stainless Steel 304 | Material  
 Satin | Finish

AVAILABLE DIMENSIONS

	HEIGHT	C-C-D	C-C-W
<b>HD01A</b>	60cm	36cm	
<b>HD01B/HD01BW</b>	80cm	50cm	62,5cm
<b>HD01C/HD01CW</b>	100cm	60cm	82,5cm
<b>HD01D/HD01DW</b>	120cm	80cm	90cm
<b>HD01E/HD01EW</b>	150cm	100cm	102,5cm
<b>HD01F/HD01FW</b>	180cm	120cm	130cm
<b>HD01G</b>	200cm	140cm	
<b>HD01H</b>	50cm	23cm	

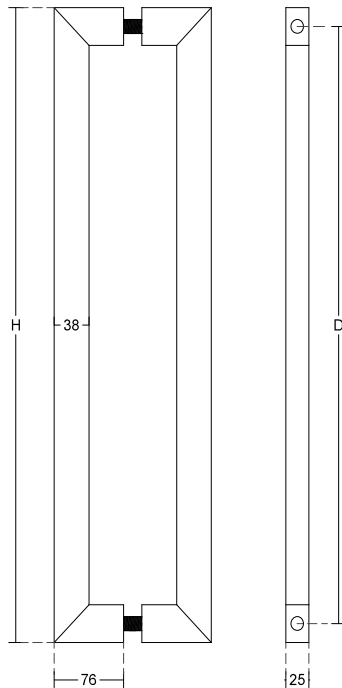
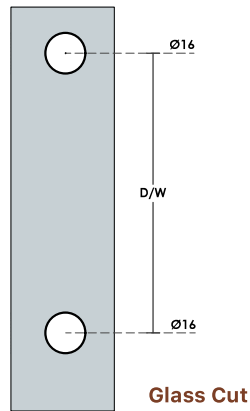

**PCA-HD03**  
**Door Handle 25x38 mm**  
 10 mm | Glass Thickness  
 Stainless Steel 304 | Material  
 Satin | Finish

AVAILABLE DIMENSIONS

	HEIGHT	C-C-D
<b>HD03A</b>	64cm	60cm
<b>HD03B</b>	104cm	100cm
<b>HD03C</b>	144cm	140cm
<b>HD03D</b>	36cm	32cm

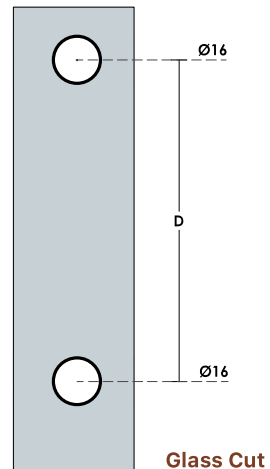

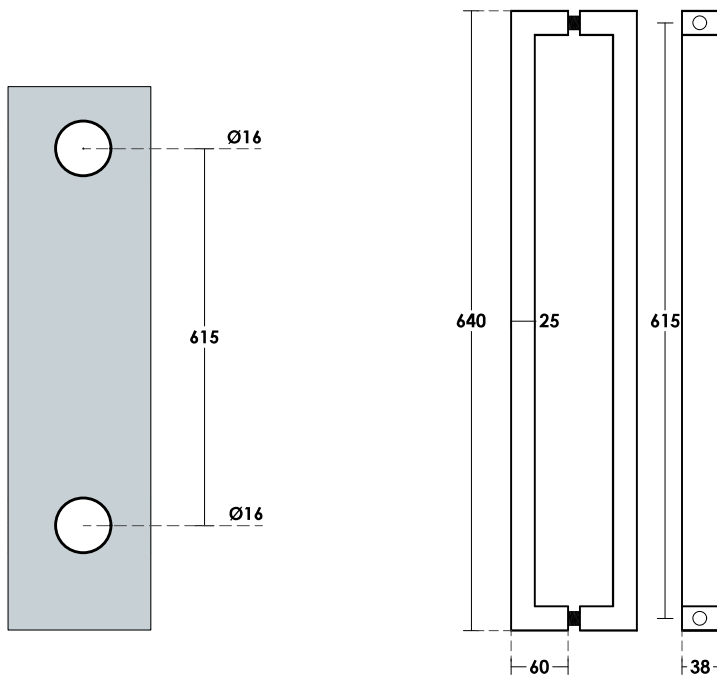

**PCA-HD13**  
**Door Handle 38x25 mm**  
 10 mm | Glass Thickness  
 Stainless Steel 304 | Material  
 Satin | Finish

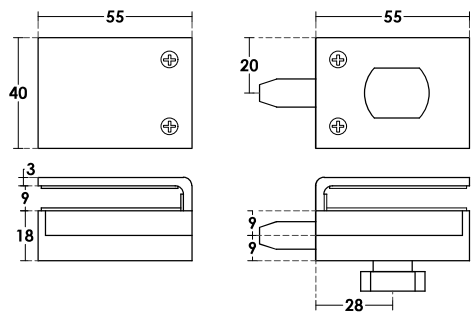

**PCA-BL08**  
**Glass-Glass Bolt**  
 10,12 mm | Glass Thickness  
 Zinc Alloy | Material  
 Satin | Finish

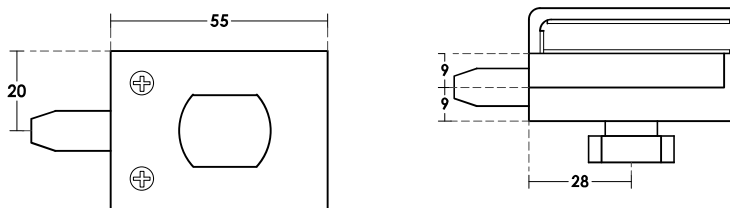

**PCA-BL08S**  
**Wall-Glass Bolt**  
 10,12 mm | Glass Thickness  
 Zinc Alloy | Material  
 Satin | Finish

HD06



HD06A

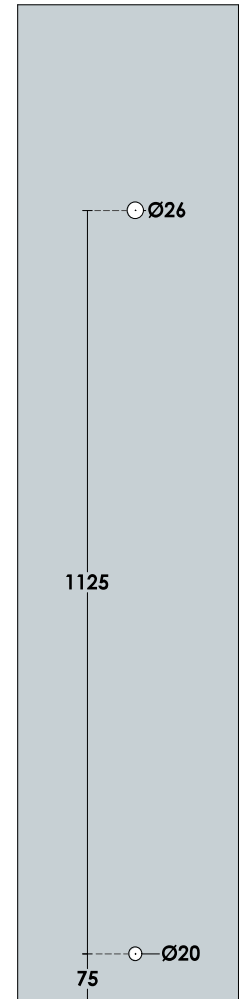
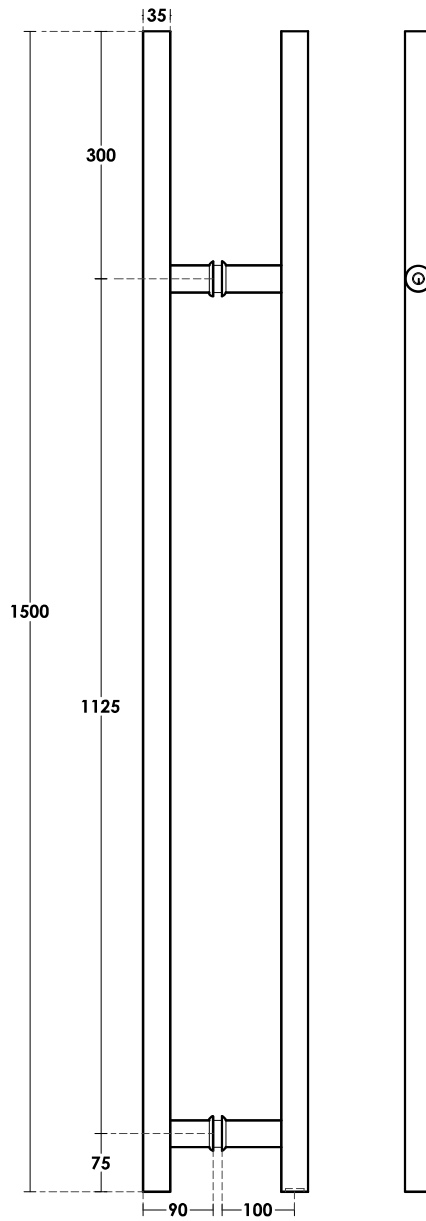

**PCA-HD06**  
**Door Lock - Handle  $\varnothing 35\text{mm}$**   
 10-12 mm | Glass Thickness  
 Stainless Steel 304 | Material  
 Satin | Finish

**Glass Cut**

NEW

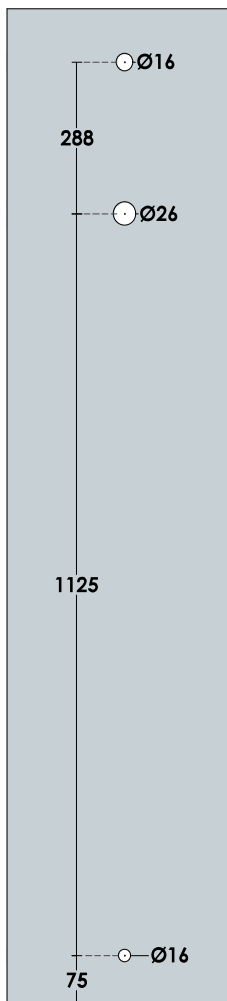

Glass Cut

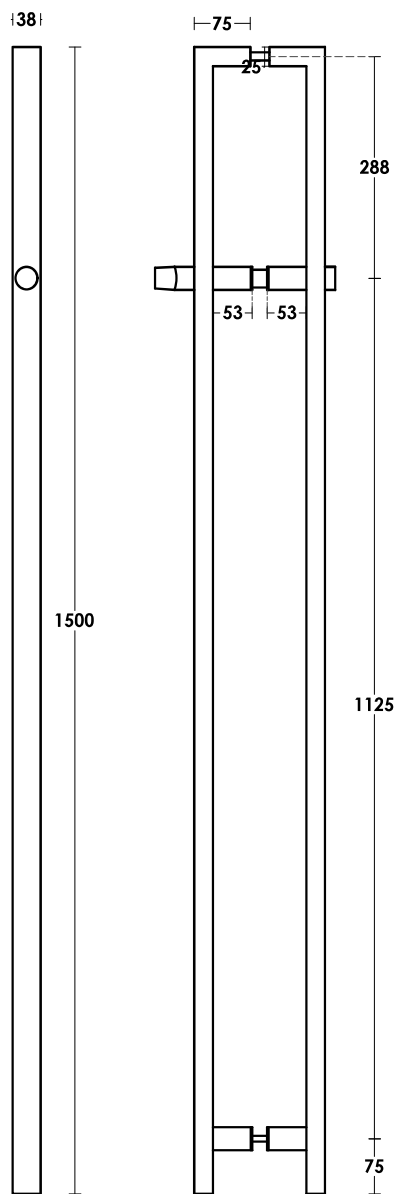

FACADES

**PCA-HD14**  
**Door Lock - Handle Ø35mm**  
 10-12 mm | Glass Thickness  
 Stainless Steel 304 | Material  
 Satin | Finish