

pag. 102\_ Intro  
pag. 105\_ Serrature  
con perno/catenaccio  
pag. 114\_ Serrature  
senza tacca  
pag. 116\_ Serrature  
con perno/catenaccio  
e maniglia  
pag. 121\_ Serrature  
per porte scorrevoli  
pag. 125\_ Serrature per mobili  
pag. 131\_ Serrature con scrocco  
pag. 137\_ Maniglie per  
serrature con scrocco  
pag. 138\_ Serrature con scrocco  
e maniglia  
pag. 143\_ Serrature con rullo

## serrature

Sistemi di chiusura di vario tipo per porte d'ingresso, interne, box doccia e mobili corredati da relativi accessori.

**OXIDAL**  
your\_project\_partner

## locks

*Various types of closing systems for entrance doors, internal doors, showers and furniture with relating accessories.*

pag. 102\_ Intro  
pag. 105\_ Locks with pin or bolt  
pag. 114\_ Locks without cutout  
pag. 116\_ Locks with pin or bolt  
and handle  
pag. 121\_ Locks  
for sliding doors  
pag. 125\_ Locks for furnitures  
pag. 131\_ Spring latch locks  
pag. 137\_ Spring latch locks  
handles  
pag. 138\_ Spring latch locks  
with handle  
pag. 143\_ Locks with roller



**Serrature con catenaccio o perno**  
Locks with pin

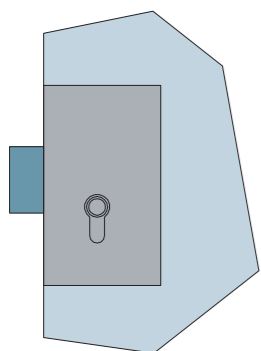

**Serrature con meccanismo a scrocco**  
Locks with latch mechanism

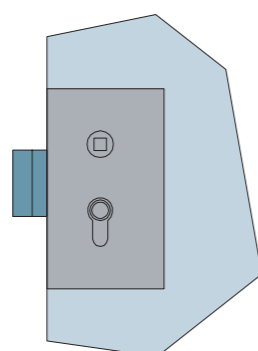

**Serrature con meccanismo a rullo**  
Locks with roller mechanism

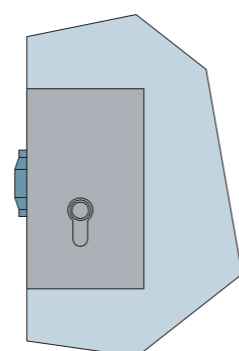

Aperture possibili  
Possible positions

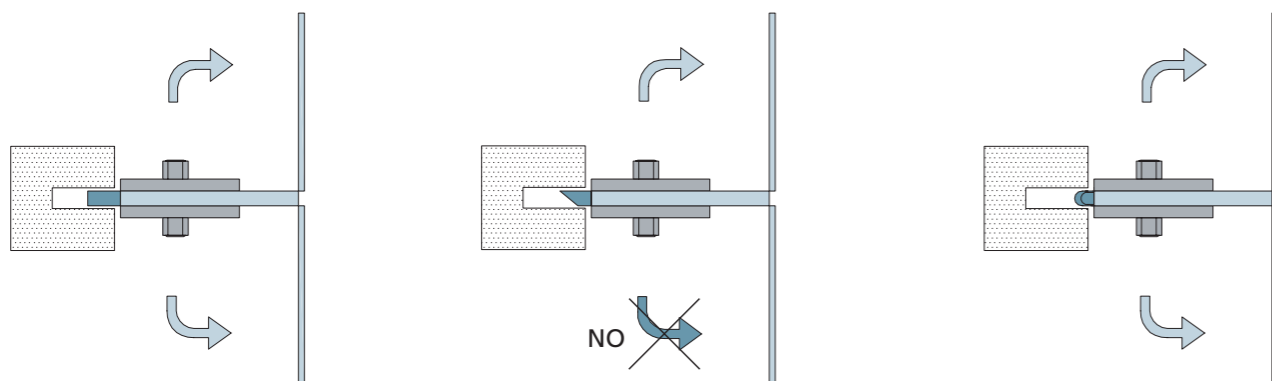

Serrature con catenaccio o perno  
Locks with pin

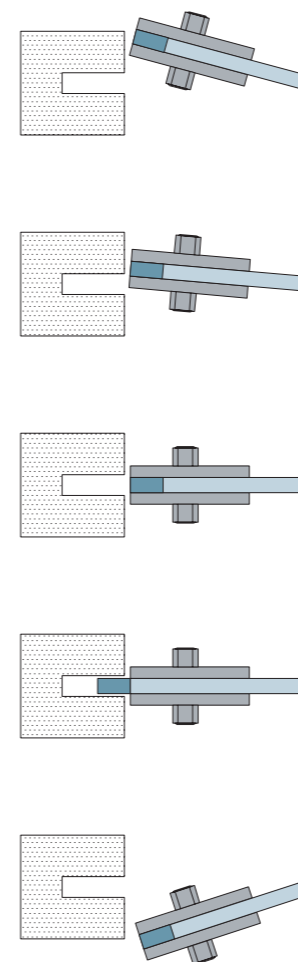

Serrature con meccanismo a scrocco  
Locks with latch mechanism

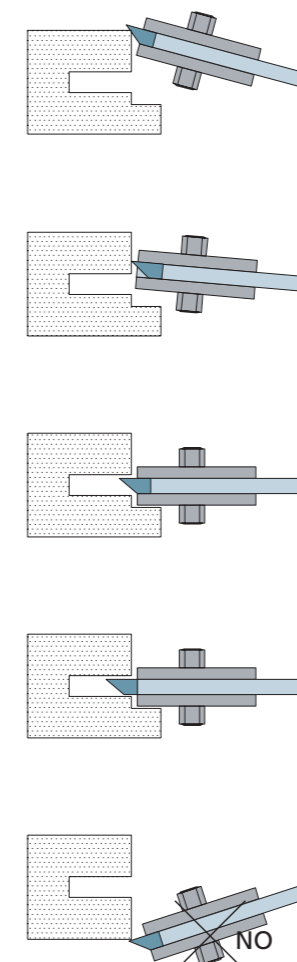

Serrature con meccanismo a rullo  
Locks with roller mechanism

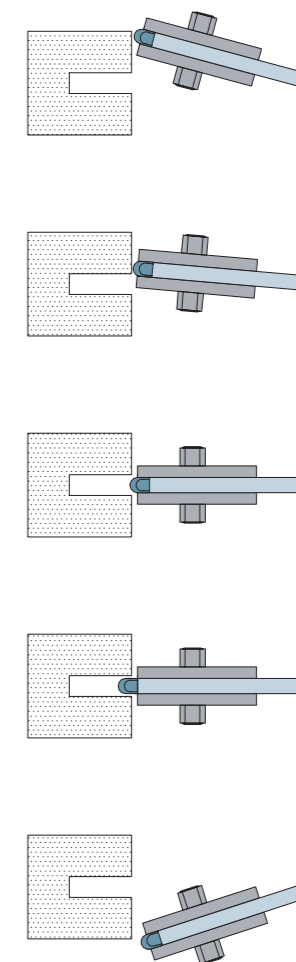

Posizione perno  
in fase di chiusura  
Pin position while  
closing

Posizione perno  
in fase di chiusura  
Pin position while  
closing

Posizione perno  
a porta chiusa  
Pin position with  
door closed

Posizione perno  
a porta chiusa a chiave  
Pin position with  
door locked

Aperture a doppio  
senso  
Swinging openings

**Serrature**

Le serrature si differenziano in 3 categorie in base al tipo di chiusura:

- **Serrature con catenaccio o perno**  
Serrature manuali che consentono l'apertura da entrambe i lati, il perno rimane all'interno del corpo della serratura e solo in seguito alla mandata (giro di chiave) il perno fuoriesce per la chiusura.
- **Serrature con meccanismo scrocco**  
Il perno rimane sporgente rispetto al corpo della serratura. La sua forma triangolare e la molla interna del meccanismo consentono al perno di rientrare automaticamente in fase di chiusura per uscire nuovamente e bloccare la porta, in questo caso la porta non è chiusa ma può essere aperta tramite una maniglia

**Locks**

Locks are divided into 3 categories according to the closing pin:

- **Lock with pin or bolt**  
Manual locks with opening on both sides, the pin remains inside the lock until locking by the key.
- **Lock with latch mechanism**  
Pin remains outside the lock body. Its triangular shape and the internal spring of the mechanism allow the pin to fall automatically under closing again to exit and lock the door.  
In this case the door can be opened by a handle or knob: turning the handle pin falls opening is possible, to lock the door key turn is necessary.

o pomolo: agendo sulla maniglia il perno rientra rendendo possibile l'apertura, per chiudere la porta è necessario effettuare una mandata (giro di chiave).

- **Serrature con meccanismo a rullo**  
Questo tipo funziona con lo stesso concetto dello scrocco ma consente l'apertura da entrambe i lati grazie al perno di forma ovale.

Lo schema sopra indicato riassume i tipi di chiusura e le relative aperture.

- **Lock with roller mechanism**  
This lock type works in the same way of latch lock but allows the opening on both sides thanks to the oval shape of the pin.

The scheme here above represents the types of pin and the different openings.



locks with pin or deadbolt

serrature con perno o catenaccio

**OXIDAL**  
your\_project\_partner



legenda / legenda

portata / load	spessori / thickness
-	8 - 12

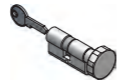
C. P.  

 Cilindro con chiave e pomolo Cod. CP  
 Cylinder with key and knob Cod. CP

C. U.  

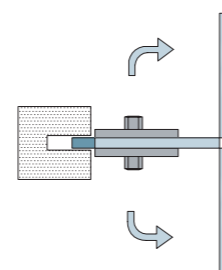
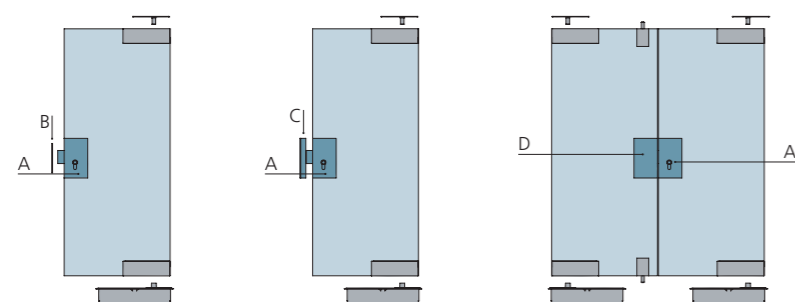
 Cilindro con chiave unificata Cod. CU  
 Cylinder with same key Cod. CU



A	B	C	D	E	F	G	H
art. 201	art. 312	art. 313	art. 202	-	-	-	-

art. 201

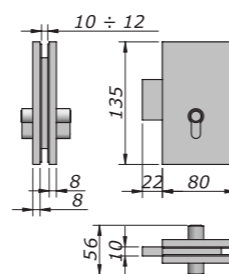
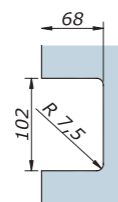

Serratura  
Lock

argento/silver	bronzo/bronze	oro/gold	nero/black	verniciato/powder	cromato/chrome	oro luc./bright gold	crom.sat/chro. mat
N-0201-A	N-0201-B	N-0201-O	N-0201-N	N-0201-V	N-0201-C	N-0201-L	N-0201-I

art. 202

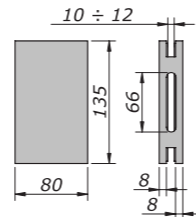
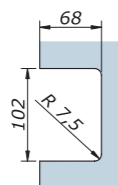

Contro per Art. 201/203  
Lock keeper for Art. 201/203

argento/silver	bronzo/bronze	oro/gold	nero/black	verniciato/powder	cromato/chrome	oro luc./bright gold	crom.sat/chro. mat
N-0202-A	N-0202-B	N-0202-O	N-0202-N	N-0202-V	N-0202-C	N-0202-L	N-0202-I

art. 312

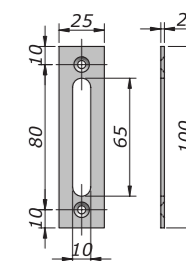

Bocchetta a 180° per Art. 201/203  
180° strike plate for Art. 201/203

argento/silver	bronzo/bronze	oro/gold	nero/black	verniciato/powder	cromato/chrome	oro luc./bright gold	crom.sat/chro. mat
N-0312-A	N-0312-B	N-0312-O	N-0312-N	N-0312-V	N-0312-C	N-0312-L	N-0312-I

art. 313

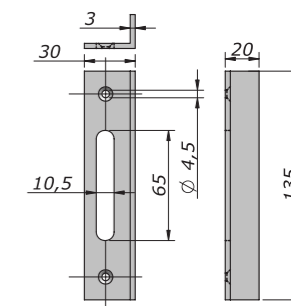

Battuta a 90° per Art. 201/203  
90° strike plate for Art. 201/203

argento/silver	bronzo/bronze	oro/gold	nero/black	verniciato/powder	cromato/chrome	oro luc./bright gold	crom.sat/chro. mat
N-0313-A	N-0313-B	N-0313-O	N-0313-N	N-0313-V	N-0313-C	N-0313-L	N-0313-I



legenda / legenda

portata / load	spessori / thickness
-	8 - 20

C. P.  
Cilindro con chiave e pomolo Cod. CP  
Cylinder with key and knob Cod. CP

C. U.  
Cilindro con chiave unificata Cod. CU  
Cylinder with same key Cod. CU

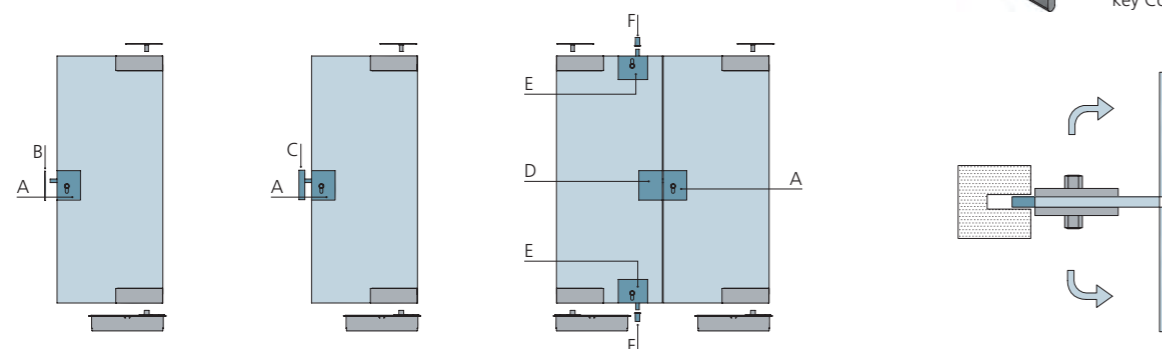

A	B	C	D	E	F	G	H
art. 220	art. 312A	art. 313A	art. 221	art. 222	art. 314	-	-

art. 220



Serratura verticale  
Vertical lock

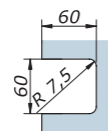

\*  
N-0220-A: max 12 mm  
N-0220-A-14: max 14 mm  
N-0220-A-18: max 18 mm  
N-0220-A-20: max 20 mm

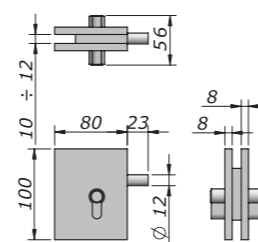

argento/silver	bronzo/bronze	oro/gold	nero/black	verniciato/powder	cromato/chrome	oro luc./bright gold	crom.sat/chro. mat
N-0220-A *	N-0220-B	N-0220-O	N-0220-N	N-0220-V	N-0220-C	N-0220-L	N-0220-I
N-0220-A-14 *	-	-	-	-	N-0220-C-14	-	N-0220-I-14
N-0220-A-18 *	-	-	-	-	N-0220-C-18	-	N-0220-I-18
N-0220-A-20 *	-	-	-	-	N-0220-C-20	-	N-0220-I-20

art. 221



Contro per Art. 220/222  
Lock keeper for Art. 220/222

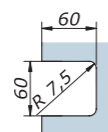

\*  
N-0221-A: max 12 mm  
N-0221-A-14: max 14 mm  
N-0221-A-18: max 18 mm  
N-0221-A-20: max 20 mm

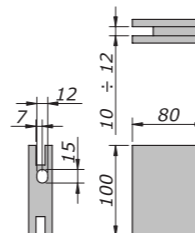

argento/silver	bronzo/bronze	oro/gold	nero/black	verniciato/powder	cromato/chrome	oro luc./bright gold	crom.sat/chro. mat
N-0221-A *	N-0221-B	N-0221-O	N-0221-N	N-0221-V	N-0221-C	N-0221-L	N-0221-I
N-0221-A-14 *	-	-	-	-	N-0221-C-14	-	N-0221-I-14
N-0221-A-18 *	-	-	-	-	N-0221-C-18	-	N-0221-I-18
N-0221-A-20 *	-	-	-	-	N-0221-C-20	-	N-0221-I-20

art. 222

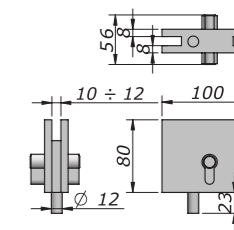
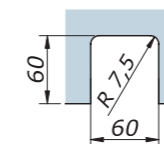

Serratura orizzontale  
Horizontal lock

argento/silver	bronzo/bronze	oro/gold	nero/black	verniciato/powder	cromato/chrome	oro luc./bright gold	crom.sat/chro. mat
N-0222-A	N-0222-B	N-0222-O	N-0222-N	N-0222-V	N-0222-C	N-0222-L	N-0222-I

art. 312A



Bocchetta a 180° per art. 220/222/900  
180° strike plate Art. 220/222/900

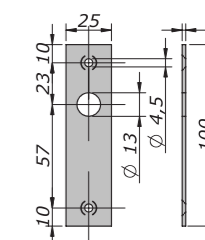

argento/silver	bronzo/bronze	oro/gold	nero/black	verniciato/powder	cromato/chrome	oro luc./bright gold	crom.sat/chro. mat
N-312A-A	N-312A-B	N-312A-O	N-312A-N	N-312A-V	N-312A-C	N-312A-L	N-312A-I

art. 313A



Battuta a 90° per Art. 220/222  
90° strike plate for Art. 220/222

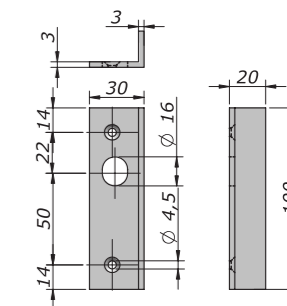

argento/silver	bronzo/bronze	oro/gold	nero/black	verniciato/powder	cromato/chrome	oro luc./bright gold	crom.sat/chro. mat
N-313A-A-DX	N-313A-B-DX	N-313A-O-DX	N-313A-N-DX	N-313A-V-DX	N-313A-C-DX	N-313A-L-DX	N-313A-I-DX
N-313A-A-SX	N-313A-B-SX	N-313A-O-SX	N-313A-N-SX	N-313A-V-SX	N-313A-C-SX	N-313A-L-SX	N-313A-I-SX

art. 314



Bussola a pavimento grande  
Big floor bush

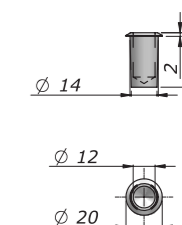

argento/silver	bronzo/bronze	oro/gold	nero/black	verniciato/powder	cromato/chrome	oro luc./bright gold	crom.sat/chro. mat
N-0314-A	N-0314-B	N-0314-O	N-0314-N	N-0314-V N	N-0314-C	N-0314-L	N-0314-I

legenda / legenda

portata / load	spessori / thickness
-	8 - 12

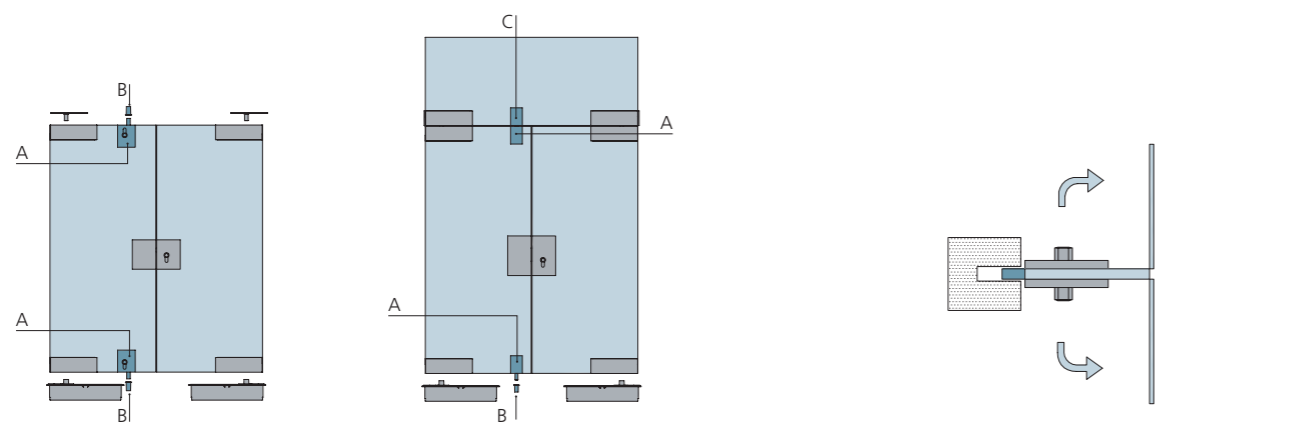

A	B	C	D	E	F	G	H
art. 240/242	art. 314	art. 241	-	-	-	-	-

art. 240

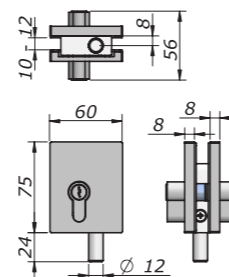
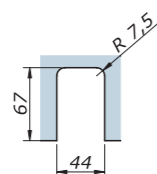

Serratura piccola  
Small lock

argento/silver	bronzo/bronze	oro/gold	nero/black	verniciato/powder	cromato/chrome	oro luc./bright gold	crom.sat/chro. mat
N-0240-A	N-0240-B	N-0240-O	N-0240-N	N-0240-V	N-0240-C	N-0240-L	N-0240-I

art. 241

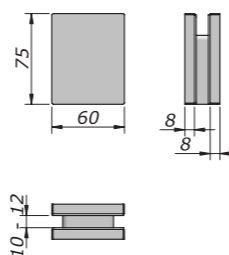
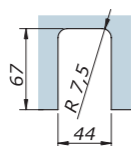

Contro per Art. 240/242  
Lock keeper for Art. 240/242

argento/silver	bronzo/bronze	oro/gold	nero/black	verniciato/powder	cromato/chrome	oro luc./bright gold	crom.sat/chro. mat
N-0241-A	N-0241-B	N-0241-O	N-0241-N	N-0241-V	N-0241-C	N-0241-L	N-0241-I

art. 242

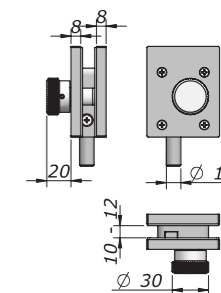
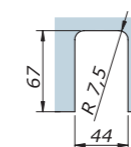

Catenaccio con pomolo  
Big bolt with knob

argento/silver	bronzo/bronze	oro/gold	nero/black	verniciato/powder	cromato/chrome	oro luc./bright gold	crom.sat/chro. mat
N-0242-A	N-0242-B	N-0242-O	N-0242-N	N-0242-V	N-0242-C	N-0242-L	N-0242-I

art. 314

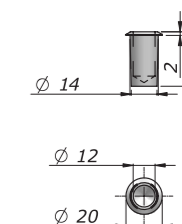

Bussola a pavimento grande  
Big floor bush

argento/silver	bronzo/bronze	oro/gold	nero/black	verniciato/powder	cromato/chrome	oro luc./bright gold	crom.sat/chro. mat
N-0314-A	N-0314-B	N-0314-O	N-0314-N	N-0314-V N	N-0314-C	N-0314-L	N-0314-I



legenda / legenda

portata / load	spessori / thickness
-	8 - 12

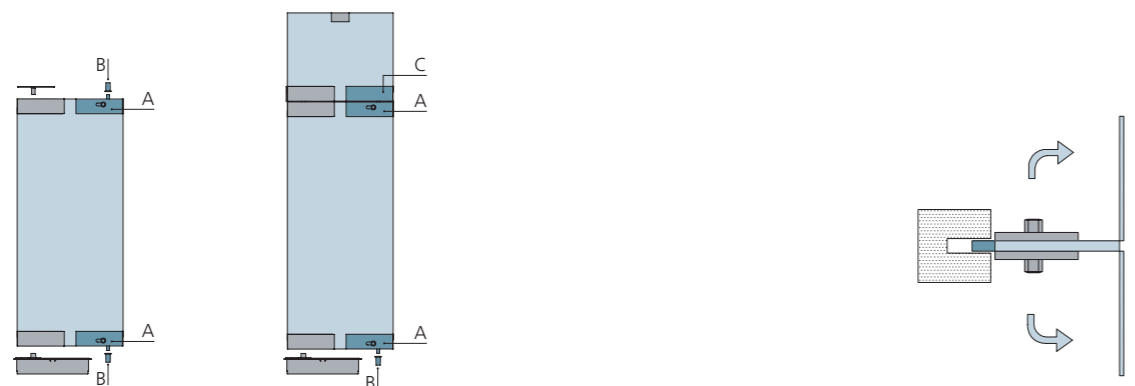

A	B	C	D	E	F	G	H
art. 235	art. 316	art. 236	-	-	-	-	-

art. 316



Bussola a pavimento piccola  
Small floor bush

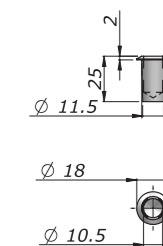

argento/silver	bronzo/bronze	oro/gold	nero/black	verniciato/powder	cromato/chrome	oro luc./bright gold	crom.sat/chro. mat
N-0316-A	N-0316-B	N-0316-O	N-0316-N	N-0316-V	N-0316-C	N-0316-L	N-0316-I

art. 235

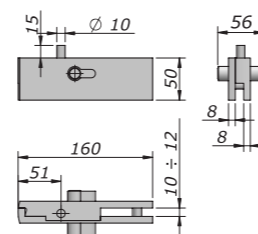
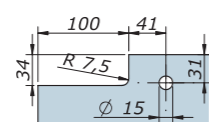

Serratura d'angolo  
Corner lock

argento/silver	bronzo/bronze	oro/gold	nero/black	verniciato/powder	cromato/chrome	oro luc./bright gold	crom.sat/chro. mat
N-0235-A	N-0235-B	N-0235-O	N-0235-N	N-0235-V	N-0235-C	N-0235-L	N-0235-I

art. 236

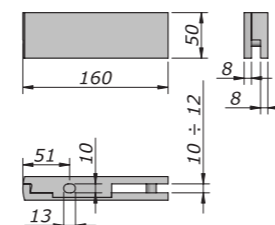
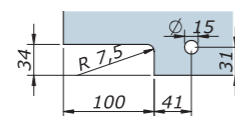

Contro per Art. 235  
Lock keeper for Art. 235

argento/silver	bronzo/bronze	oro/gold	nero/black	verniciato/powder	cromato/chrome	oro luc./bright gold	crom.sat/chro. mat
N-0236-A	N-0236-B	N-0236-O	N-0236-N	N-0236-V	N-0236-C	N-0236-L	N-0236-I

legenda / legenda

portata / load	spessori / thickness
-	10

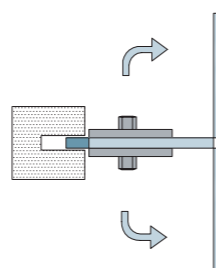
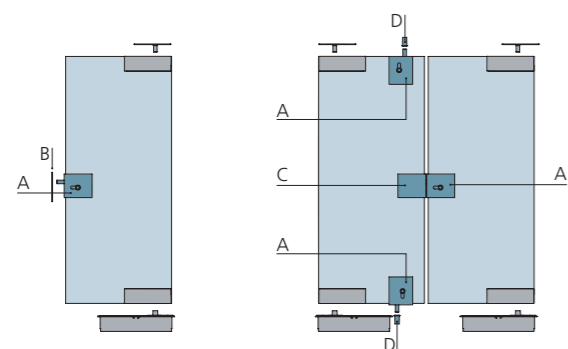

A	B	C	D	E	F	G	H
art. 900	art. 312A	art. 901	art. 314	-	-	-	-

art. 900

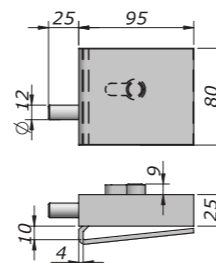
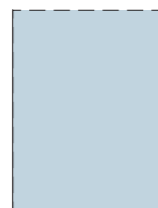

Serratura senza tacca  
Lock without cutout

argento/silver	bronzo/bronze	oro/gold	nero/black	verniciato/powder	cromato/chrome	oro luc./bright gold	crom.sat/chro. mat
N-0900-A	N-0900-B	N-0900-O	N-0900-N	N-0900-V	N-0900-C	N-0900-L	N-0900-I

art. 901

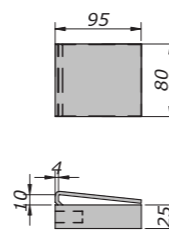
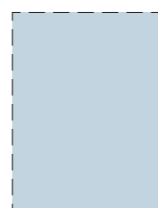

Contro per Art. 900  
Lock keeper for Art. 900

argento/silver	bronzo/bronze	oro/gold	nero/black	verniciato/powder	cromato/chrome	oro luc./bright gold	crom.sat/chro. mat
N-0901-A	N-0901-B	N-0901-O	N-0901-N	N-0901-V	N-0901-C	N-0901-L	N-0901-I

art. 314



Bussola a pavimento grande  
Big floor bush

argento/silver	bronzo/bronze	oro/gold	nero/black	verniciato/powder	cromato/chrome	oro luc./bright gold	crom.sat/chro. mat
N-0314-A	N-0314-B	N-0314-O	N-0314-N	N-0314-V	N-0314-C	N-0314-L	N-0314-I

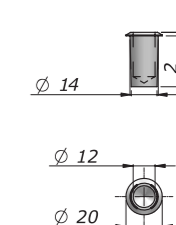

art. 312A



Bocchetta a 180° per art. 220/222/900  
180° strike plate Art. 220/222/900

argento/silver	bronzo/bronze	oro/gold	nero/black	verniciato/powder	cromato/chrome	oro luc./bright gold	crom.sat/chro. mat
N-312A-A	N-312A-B	N-312A-O	N-312A-N	N-312A-V	N-312A-C	N-312A-L	N-312A-I

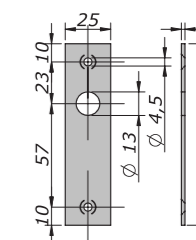



legenda / legenda

portata / load	spessori / thickness
-	8 - 12

**C. P.**  
Cilindro con chiave e pomolo Cod. CP  
Cylinder with key and knob Cod. CP

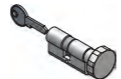

**C. U.**  
Cilindro con chiave unificata Cod. CU  
Cylinder with same key Cod. CU

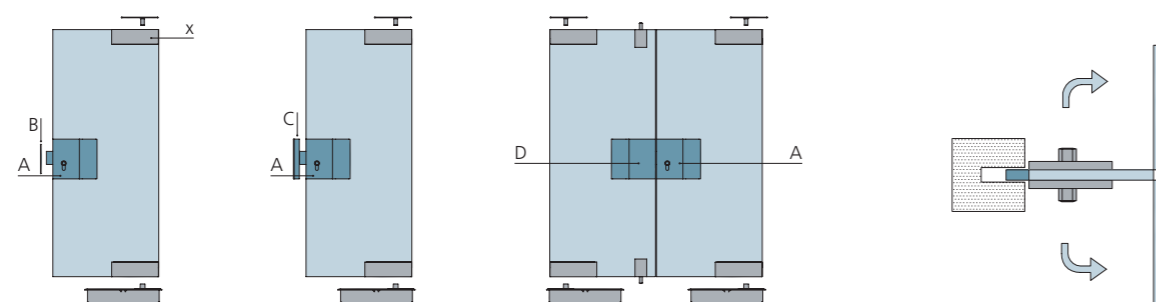
A	B	C	D	E	F	G	H
art. 203	art. 312	art. 313	art. 204	-	-	-	-

art. 203

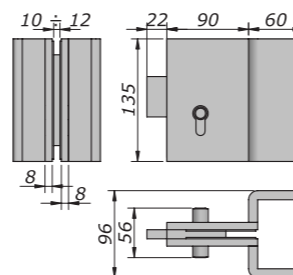
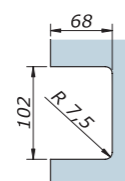

Serratura con maniglie  
Lock with handles

argento/silver	bronzo/bronze	oro/gold	nero/black	verniciato/powder	cromato/chrome	oro luc./bright gold	crom.sat/chro. mat
N-0203-A	N-0203-B	N-0203-O	N-0203-N	N-0203-V	N-0203-C	N-0203-L	N-0203-I

art. 204

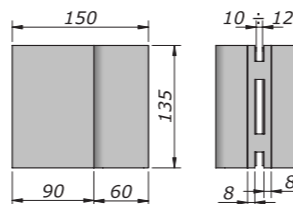
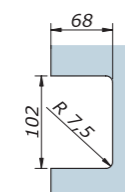

Contro per Art. 203  
Lock keeper for Art. 203

argento/silver	bronzo/bronze	oro/gold	nero/black	verniciato/powder	cromato/chrome	oro luc./bright gold	crom.sat/chro. mat
N-0204-A	N-0204-B	N-0204-O	N-0204-N	N-0204-V	N-0204-C	N-0204-L	N-0204-I

art. 312

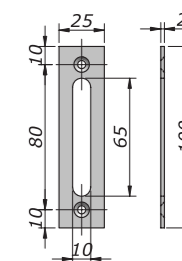

Bocchetta 180° per Art. 201/203  
180° strike plate Art. 201/203

argento/silver	bronzo/bronze	oro/gold	nero/black	verniciato/powder	cromato/chrome	oro luc./bright gold	crom.sat/chro. mat
N-0312-A	N-0312-B	N-0312-O	N-0312-N	N-0312-V	N-0312-C	N-0312-L	N-0312-I

art. 313

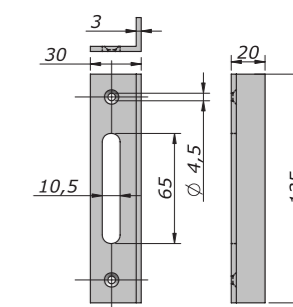

Battuta a 90° per Art. 201/203  
90° strike plate for Art. 201/203

argento/silver	bronzo/bronze	oro/gold	nero/black	verniciato/powder	cromato/chrome	oro luc./bright gold	crom.sat/chro. mat
N-0313-A	N-0313-B	N-0313-O	N-0313-N	N-0313-V	N-0313-C	N-0313-L	N-0313-I



legenda / legenda

portata / load	spessori / thickness
-	8 - 12

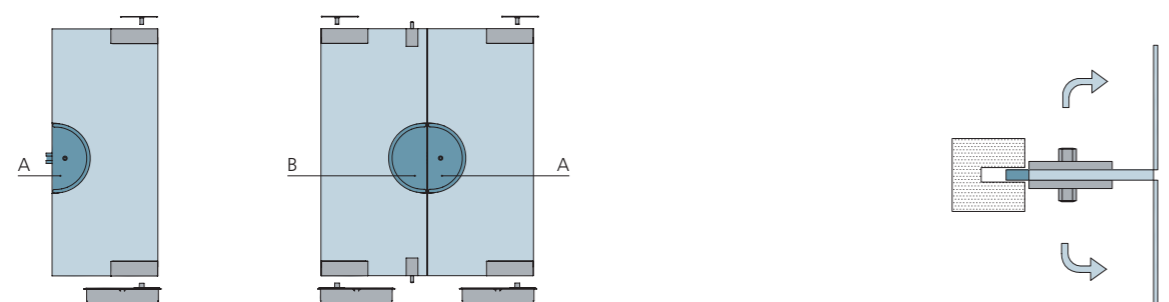

A	B	C	D	E	F	G	H
art. 250	art. 251	-	-	-	-	-	-

art. 250



Serratura a mezzaluna  
Half moon lock

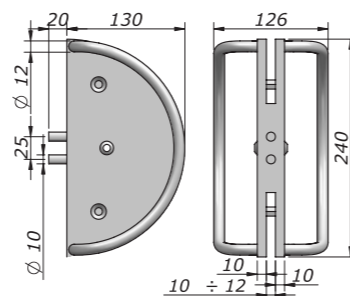
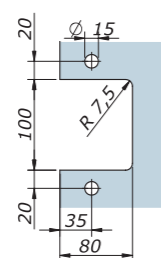

argento/silver	bronzo/bronze	oro/gold	nero/black	verniciato/powder	cromato/chrome	oro luc./bright gold	crom.sat/chro. mat
N-0250-A	N-0250-B	N-0250-O	N-0250-N	N-0250-V	N-0250-C	N-0250-L	N-0250-I

art. 251



Contro per Art. 250  
Lock keeper for Art. 250

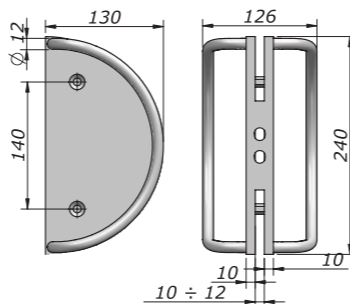
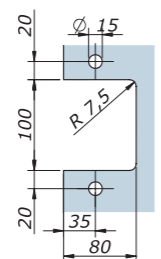

argento/silver	bronzo/bronze	oro/gold	nero/black	verniciato/powder	cromato/chrome	oro luc./bright gold	crom.sat/chro. mat
N-0251-A	N-0251-B	N-0251-O	N-0251-N	N-0251-V	N-0251-C	N-0251-L	N-0251-I

portata / load	spessori / thickness
-	8 - 12

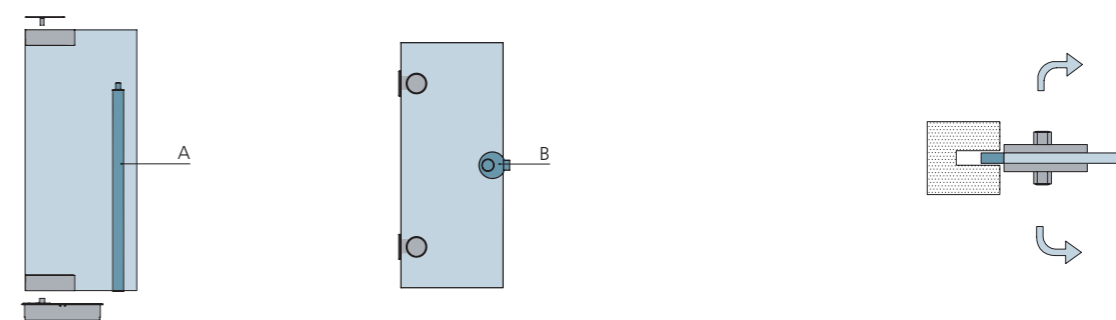

A	B	C	D	E	F	G	H
art. 30	art. 142	-	-	-	-	-	-

art. 30



Maniglione tubolare con chiave su un lato  
Tubular handle with lock on one side

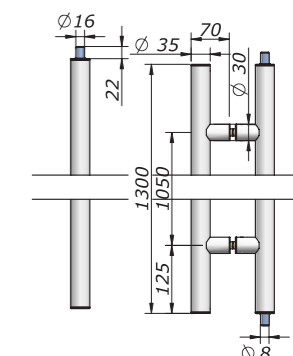
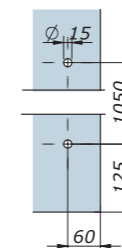

argento/silver	bronzo/bronze	oro/gold	nero/black	verniciato/powder	cromato/chrome	oro luc./bright gold	crom.sat/chro. mat
N-0030-A	-	-	-	-	N-0030-C	-	N-0030-I

art. 142



Serratura per doccia  
Shower lock

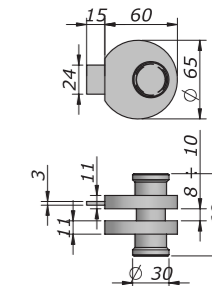
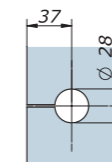

argento/silver	bronzo/bronze	oro/gold	nero/black	verniciato/powder	cromato/chrome	oro luc./bright gold	crom.sat/chro. mat
N-0142-A	N-0142-B	N-0142-O	N-0142-N	N-0142-V	N-0142-C	N-0142-L	N-0142-I



serrature per scorrevoli

sliding locks

**OXIDAL**  
your\_project\_partner



legenda / legenda

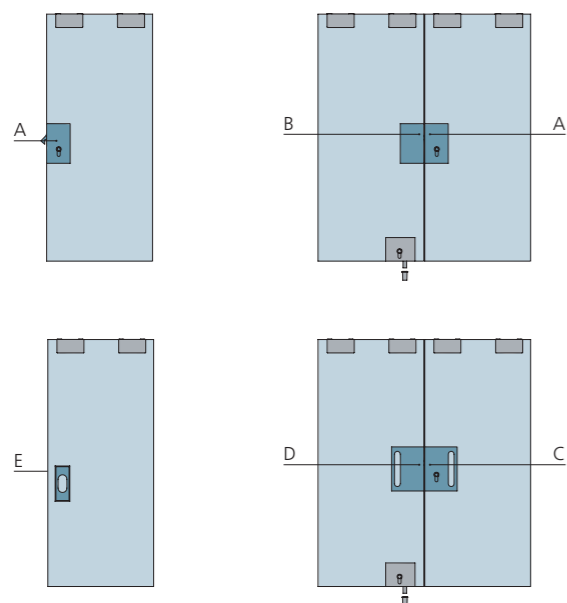

portata / load	spessori / thickness
-	8 - 12

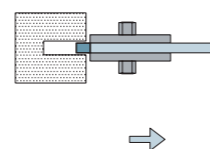
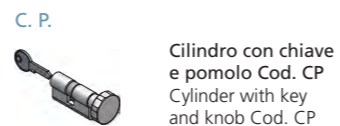

A	B	C	D	E	F	G	H
art. 232A	art. 233	art. 234	art. 237	art. 463	-	-	-

art. 232A

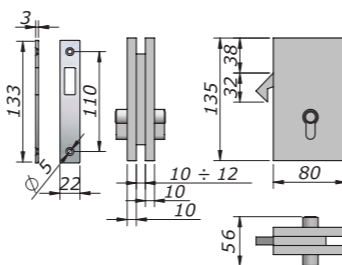
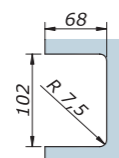

Serratura con gancio per scorrevoli  
Sliding door lock with hook

argento/silver	bronzo/bronze	oro/gold	nero/black	verniciato/powder	cromato/chrome	oro luc./bright gold	crom.sat/chro. mat
N-232A-A	-	-	N-232A-N	-	N-232A-C	-	N-232A-I

art. 233

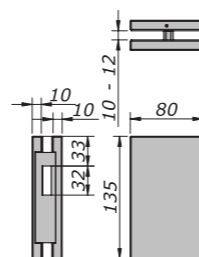
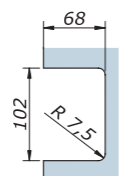

Contro per Art. 232A  
Lock keeper for Art. 232A

argento/silver	bronzo/bronze	oro/gold	nero/black	verniciato/powder	cromato/chrome	oro luc./bright gold	crom.sat/chro. mat
N-0233-A	-	-	N-0233-N	-	N-0233-C	-	N-0233-I

art. 234

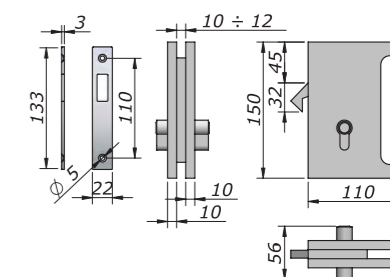
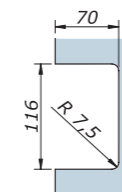

Serratura con gancio e maniglia per scorrevoli  
Sliding door lock with hook and handle

argento/silver	bronzo/bronze	oro/gold	nero/black	verniciato/powder	cromato/chrome	oro luc./bright gold	crom.sat/chro. mat
N-0234-A	-	-	N-0234-N	-	N-0234-C	-	N-0234-I

art. 237

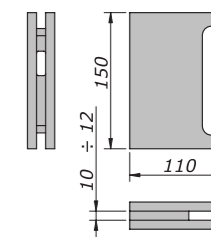
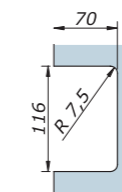

Contro con maniglia per Art. 234  
Lock keeper with handle for Art.234

argento/silver	bronzo/bronze	oro/gold	nero/black	verniciato/powder	cromato/chrome	oro luc./bright gold	crom.sat/chro. mat
N-0237-A	-	-	N-0237-N	-	N-0237-C	-	N-0237-I

art. 463

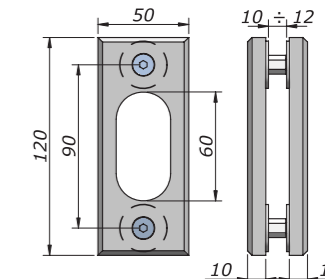
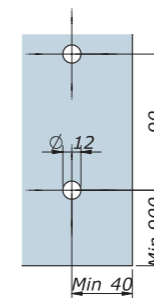

Maniglia per porte scorrevoli  
Sliding doors handle

argento/silver	bronzo/bronze	oro/gold	nero/black	verniciato/powder	cromato/chrome	oro luc./bright gold	crom.sat/chro. mat
N-0463-A	-	-	-	-	N-0463-C	-	N-0463-I



locks for furniture

serrature per mobili

**OXIDAL**  
your\_project\_partner



legenda / legenda

portata / load	spessori / thickness
-	6 - 8

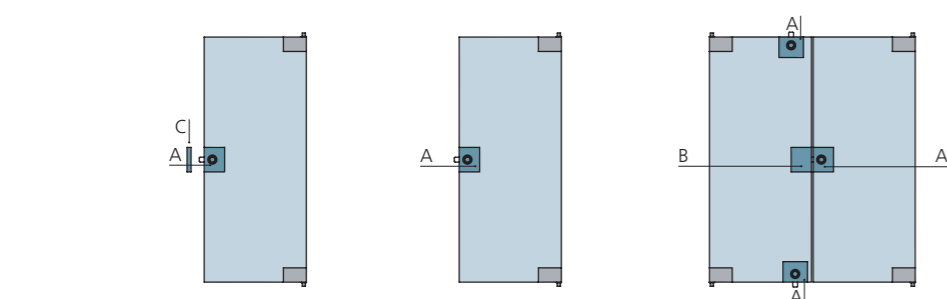

A	B	C	D	E	F	G	H
art. 180A/294	art. 181A/295	art. 313E	-	-	-	-	-

art. 180A

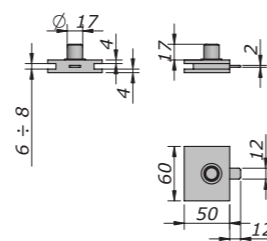
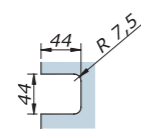

Serratura piccola per mobili  
Small lock for furniture

argento/silver	bronzo/bronze	oro/gold	nero/black	verniciato/powder	cromato/chrome	oro luc./bright gold	crom.sat/chro. mat
N-180A-A	N-180A-B	N-180A-O	N-180A-N	N-180A-V	N-180A-C	N-180A-L	N-180A-I

art. 181A

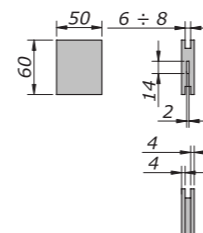
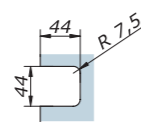

Contro per Art. 180/A  
Lock keeper for Art. 180/A

argento/silver	bronzo/bronze	oro/gold	nero/black	verniciato/powder	cromato/chrome	oro luc./bright gold	crom.sat/chro. mat
N-181A-A	N-181A-B	N-181A-O	N-181A-N	N-181A-V	N-181A-C	N-181A-L	N-181A-I

art. 313E

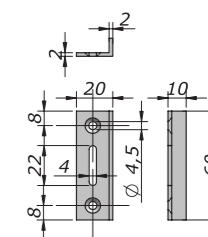

Battuta a 90° per Art. 180A  
90° strike plate for Art. 180A

argento/silver	bronzo/bronze	oro/gold	nero/black	verniciato/powder	cromato/chrome	oro luc./bright gold	crom.sat/chro. mat
N-313E-A	N-313E-B	N-313E-O	N-313E-N	N-313E-V	N-313E-C	N-313E-L	N-313E-I

art. 294

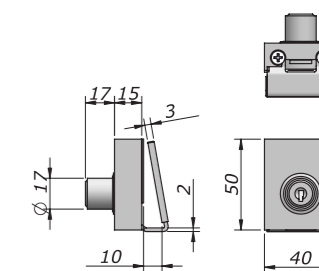

Serratura piccola senza tacca  
Small lock without cut out

argento/silver	bronzo/bronze	oro/gold	nero/black	verniciato/powder	cromato/chrome	oro luc./bright gold	crom.sat/chro. mat
N-0294-A	N-0294-B	N-0294-O	N-0294-N	N-0294-V	N-0294-C	N-0294-L	N-0294-I

art. 295

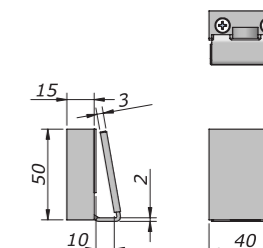

Contro per Art. 294  
Lock keeper for Art. 294

argento/silver	bronzo/bronze	oro/gold	nero/black	verniciato/powder	cromato/chrome	oro luc./bright gold	crom.sat/chro. mat
N-0295-A	N-0295-B	N-0295-O	N-0295-N	N-0295-V	N-0295-C	N-0295-L	N-0295-I

art. 142

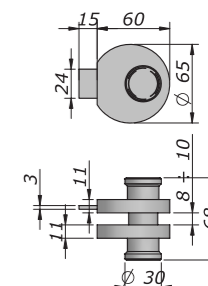
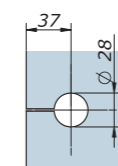

Serratura per doccia  
Shower lock

argento/silver	bronzo/bronze	oro/gold	nero/black	verniciato/powder	cromato/chrome	oro luc./bright gold	crom.sat/chro. mat
N-0142-A	N-0142-B	N-0142-O	N-0142-N	N-0142-V	N-0142-C	N-0142-L	N-0142-I

legenda / legenda

portata / load	spessori / thickness
-	max 5

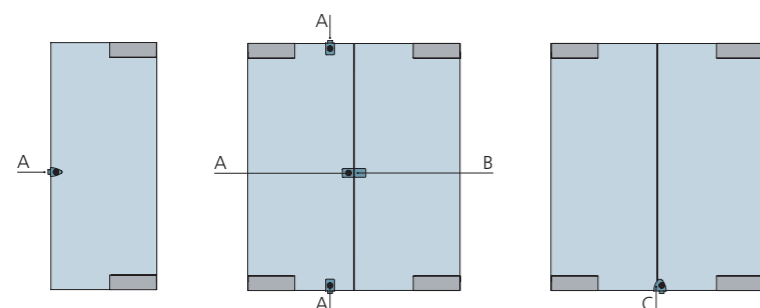

A	B	C	D	E	F	G	H
art. 286/296	art. 287/297	art. 288/298	-	-	-	-	-

art. 286-296



Serratura senza tacca per mobili  
Small furniture lock without cut-out

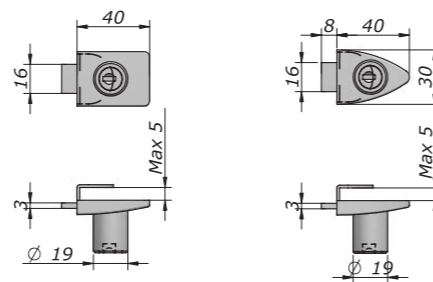

art.286 art.296

argento/silver	bronzo/bronze	oro/gold	nero/black	verniciato/powder	cromato/chrome	oro luc./bright gold	crom.sat/chro. mat
-	-	-	-	-	N-0286-C	-	N-0286-I
-	-	-	-	-	N-0296-C	-	N-0296-I

art. 287-297



Contro per Art. 286 (art. 287) e 296 (art. 297)  
Lock keeper for Art. 286 (art. 287) and 296 (art. 297)

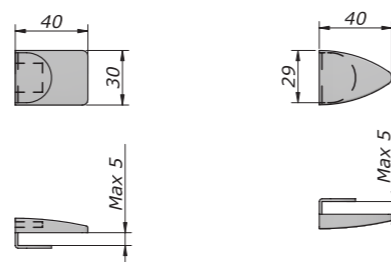

art.287 art.297

argento/silver	bronzo/bronze	oro/gold	nero/black	verniciato/powder	cromato/chrome	oro luc./bright gold	crom.sat/chro. mat
-	-	-	-	-	N-0287-C	-	N-0287-I
-	-	-	-	-	N-0297-C	-	N-0297-I

art. 288-298

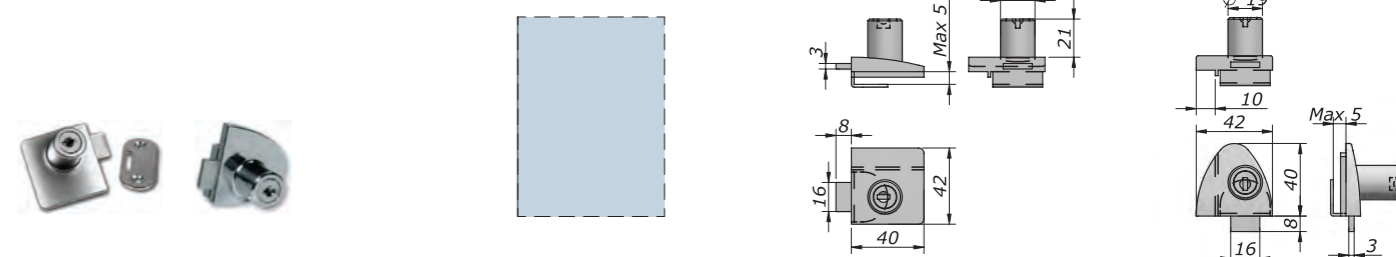

Serratura doppia senza tacca per mobili  
Double furniture lock without cut-out

art.288 art.298

argento/silver	bronzo/bronze	oro/gold	nero/black	verniciato/powder	cromato/chrome	oro luc./bright gold	crom.sat/chro. mat
-	-	-	-	-	N-0288-C	-	N-0288-I
-	-	-	-	-	N-0298-C	-	N-0298-I

art. 312C



Bocchetta a 180° per Art. 286/296-288/298  
180° strike plate Art.286/296/288/298

argento/silver	bronzo/bronze	oro/gold	nero/black	verniciato/powder	cromato/chrome	oro luc./bright gold	crom.sat/chro. mat
-	-	-	-	-	N-312C-C	-	N-312C-I

art. 18-19

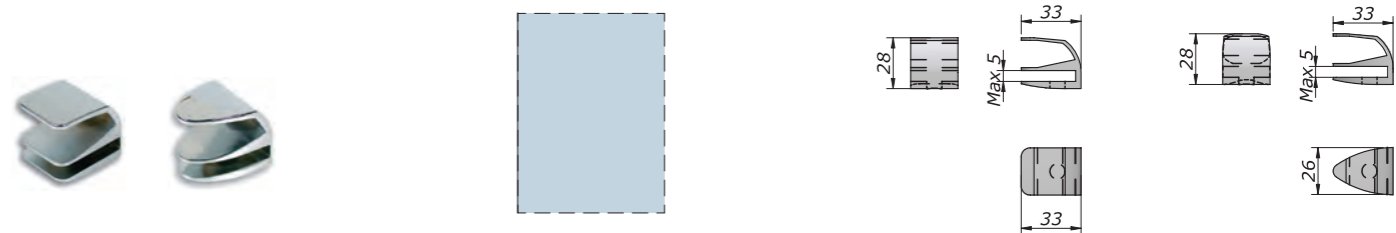

Maniglia per mobili senza tacca  
Furniture handle without cut-out

art.18 art.19

argento/silver	bronzo/bronze	oro/gold	nero/black	verniciato/powder	cromato/chrome	oro luc./bright gold	crom.sat/chro. mat
-	-	-	-	-	N-0018-C	N-0018-L	N-0018-I
-	-	-	-	-	N-0019-C	N-0019-L	N-0019-I



locks with latch mechanism

serrature con meccanismo a scrocco

**OXIDAL**  
your\_project\_partner





legenda / legenda

portata / load	spessori / thickness
-	8 - 12

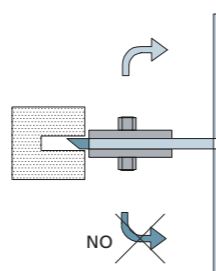
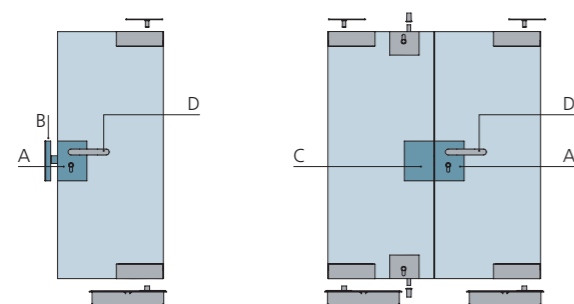

A	B	C	D	E	F	G	H
art. 205/205A	art. 313B	art. 206	pag. 137	-	-	-	-

art. 205

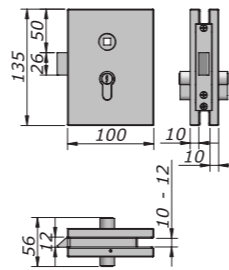
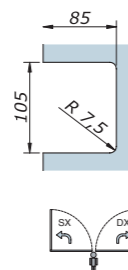

Serratura scrocco e foro maniglia  
Spring latch lock with hole for handle

argento/silver	bronzo/bronze	oro/gold	nero/black	verniciato/powder	cromato/chrome	oro luc./bright gold	crom.sat/chro. mat
N-0205-A-DX	N-0205-B-DX	N-0205-O-DX	N-0205-N-DX	N-0205-V-DX	N-0205-C-DX	N-0205-L-DX	N-0205-I-DX
N-0205-A-SX	N-0205-B-SX	N-0205-O-SX	N-0205-N-SX	N-0205-V-SX	N-0205-C-SX	N-0205-L-SX	N-0205-I-SX

art. 205A

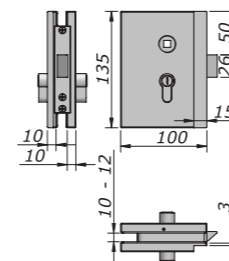
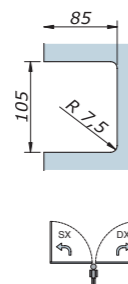

Serratura scrocco e foro maniglia con fresatura  
Spring latch lock with milling and handle hole

argento/silver	bronzo/bronze	oro/gold	nero/black	verniciato/powder	cromato/chrome	oro luc./bright gold	crom.sat/chro. mat
N-205A-A-DX	N-205A-B-DX	N-205A-O-DX	N-205A-N-DX	N-205A-V-DX	N-205A-C-DX	N-205A-L-DX	N-205A-I-DX
N-205A-A-SX	N-205A-B-SX	N-205A-O-SX	N-205A-N-SX	N-205A-V-SX	N-205A-C-SX	N-205A-L-SX	N-205A-I-SX

art. 206

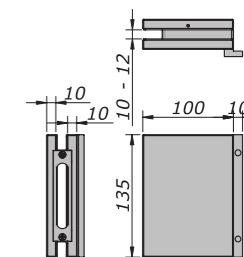
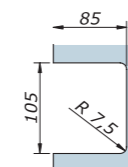

Contro per Art. 205  
Lock keeper for Art. 205

argento/silver	bronzo/bronze	oro/gold	nero/black	verniciato/powder	cromato/chrome	oro luc./bright gold	crom.sat/chro. mat
N-0206-A	N-0206-B	N-0206-O	N-0206-N	N-0206-V	N-0206-C	N-0206-L	N-0206-I

art. 313B

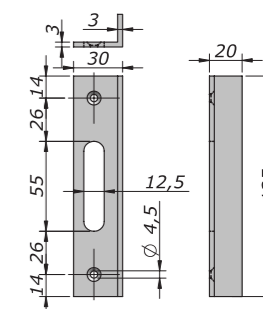

Battuta a 90° per Art. 205  
90° strike plate for Art. 205

argento/silver	bronzo/bronze	oro/gold	nero/black	verniciato/powder	cromato/chrome	oro luc./bright gold	crom.sat/chro. mat
N-313B-A	N-313B-B	N-313B-O	N-313B-N	N-313B-V	N-313B-C	N-313B-L	N-313B-I

art. 315

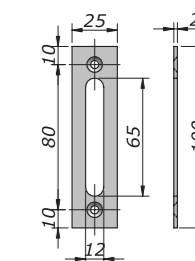

Bocchetta 180° per Art. 205  
180° strike plate Art. 205

argento/silver	bronzo/bronze	oro/gold	nero/black	verniciato/powder	cromato/chrome	oro luc./bright gold	crom.sat/chro. mat
N-0315-A	N-0315-B	N-0315-O	N-0315-N	N-0315-V	N-0315-C	N-0315-L	N-0315-I

legenda / legenda

portata / load	spessori / thickness
-	8 - 12

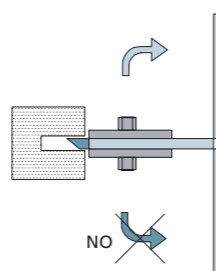
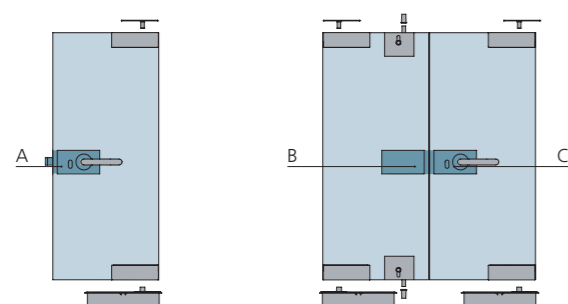

A	B	C	D	E	F	G	H
art. 208/209	art. 208/210	pag. 137	-	-	-	-	-

art. 207

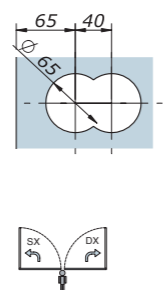

Serratura scrocco e foro maniglia  
Spring latch lock with hole for handle

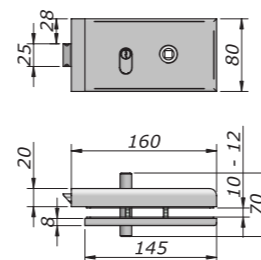

argento/silver	bronzo/bronze	oro/gold	nero/black	verniciato/powder	cromato/chrome	oro luc./bright gold	crom.sat/chro. mat
N-0207-A-DX	N-0207-B-DX	N-0207-O-DX	N-0207-N-DX	N-0207-V-DX	N-0207-C-DX	N-0207-L-DX	N-0207-I-DX
N-0207-A-SX	N-0207-B-SX	N-0207-O-SX	N-0207-N-SX	N-0207-V-SX	N-0207-C-SX	N-0207-L-SX	N-0207-I-SX

art. 208

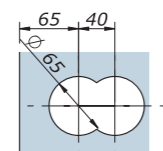

Contro per Art. 207  
Lock keeper for Art. 207

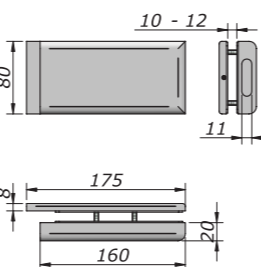

argento/silver	bronzo/bronze	oro/gold	nero/black	verniciato/powder	cromato/chrome	oro luc./bright gold	crom.sat/chro. mat
N-0208-A	N-0208-B	N-0208-O	N-0208-N	N-0208-V	N-0208-C	N-0208-L	N-0208-I

art. 209

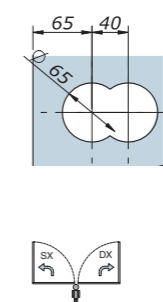

Serratura scrocco e foro maniglia  
Spring latch lock with hole for handle

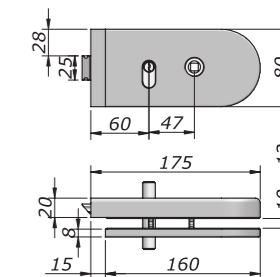

argento/silver	bronzo/bronze	oro/gold	nero/black	verniciato/powder	cromato/chrome	oro luc./bright gold	crom.sat/chro. mat
N-0209-A-DX	N-0209-B-DX	N-0209-O-DX	N-0209-N-DX	N-0209-V-DX	N-0209-C-DX	N-0209-L-DX	N-0209-I-DX
N-0209-A-SX	N-0209-B-SX	N-0209-O-SX	N-0209-N-SX	N-0209-V-SX	N-0209-C-SX	N-0209-L-SX	N-0209-I-SX

art. 210

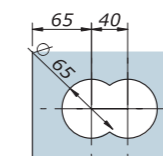

Contro per Art. 209  
Lock keeper for Art. 209

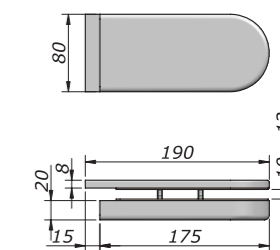

argento/silver	bronzo/bronze	oro/gold	nero/black	verniciato/powder	cromato/chrome	oro luc./bright gold	crom.sat/chro. mat
N-0210-A	N-0210-B	N-0210-O	N-0210-N	N-0210-V	N-0210-C	N-0210-L	N-0210-I

art. 215

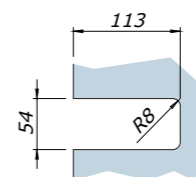

Serratura scrocco magnetico e foro maniglia  
Magnetic spring latch lock with hole for handle

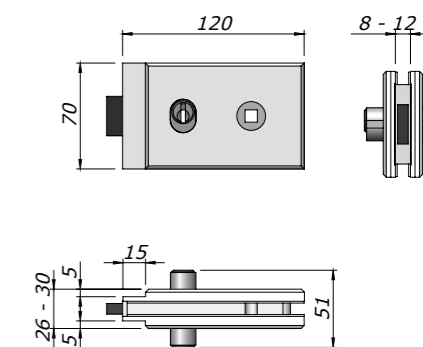

argento/silver	bronzo/bronze	oro/gold	nero/black	verniciato/powder	cromato/chrome	oro luc./bright gold	crom.sat/chro. mat
N-0215-A	N-0215-B	N-0215-O	N-0215-N	N-0215-V	N-0215-C	N-0215-L	N-0215-I

art. 216

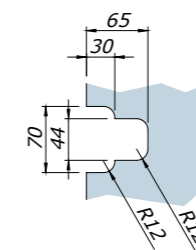

Contro per Art. 215/217  
Lock keeper for Art. 215/217

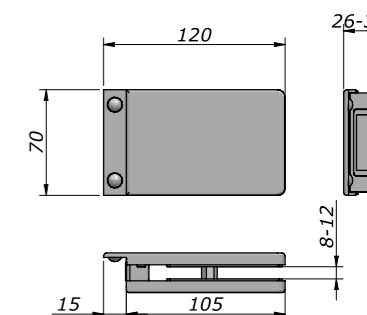

argento/silver	bronzo/bronze	oro/gold	nero/black	verniciato/powder	cromato/chrome	oro luc./bright gold	crom.sat/chro. mat
N-0216-A	N-0216-B	N-0216-O	N-0216-N	N-0216-V	N-0216-C	N-0216-L	N-0216-I

art. 217

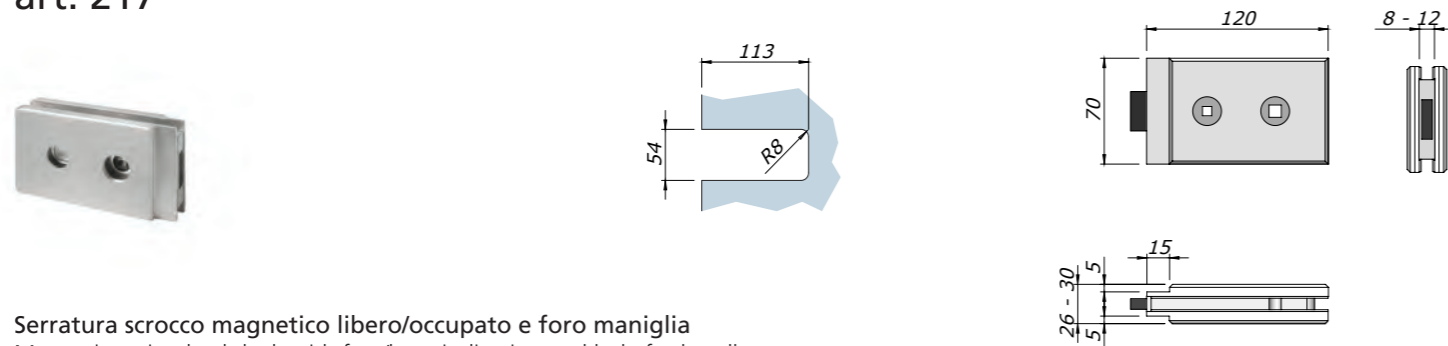

Serratura scrocco magnetico libero/occupato e foro maniglia  
Magnetic spring latch lock with free/busy indication and hole for handle

argento/silver	bronzo/bronze	oro/gold	nero/black	verniciato/powder	cromato/chrome	oro luc./bright gold	crom.sat/chro. mat
N-0217-A	N-0217-B	N-0217-O	N-0217-N	N-0217-V	N-0217-C	N-0217-L	N-0217-I

art. 218



Battuta a muro a 90° per Art. 215/217  
90° wall strike plate for Art. 215/217

argento/silver	bronzo/bronze	oro/gold	nero/black	verniciato/powder	cromato/chrome	oro luc./bright gold	crom.sat/chro. mat
N-0218-A	N-0218-B	N-0218-O	N-0218-N	N-0218-V	N-0218-C	N-0218-L	N-0218-I

legenda / legenda



art. 50



Maniglia per serrature con scrocco  
Spring latch lock handle

argento/silver	cromato/chrome	cromato/chrome
N-0050-A	-	N-0050-I

art. 51



Maniglia per serrature con scrocco  
Spring latch lock handle

argento/silver	cromato/chrome	cromato/chrome
N-0051-A	-	N-0051-I

art. 52



Bussola per installazione maniglia senza rosetta  
Bush for latch lock handle without washer

argento/silver	cromato/chrome	cromato/chrome
-	-	N-0052-I

art. 53



Maniglia per serrature con scrocco  
Spring latch lock handle

argento/silver	cromato/chrome	cromato/chrome
N-0053-A	N-0053-C	N-0053-I

art. 54



Maniglia per serrature con scrocco  
Spring latch lock handle

argento/silver	cromato/chrome	cromato/chrome
N-0054-A	N-0054-C	N-0054-I

art. 55



Nottolino per serratura a scrocco  
Spring latch lock knob

argento/silver	cromato/chrome	cromato/chrome
N-0055-A	N-0055-C	N-0055-I

legenda / legenda

portata / load	spessori / thickness
-	8 - 12

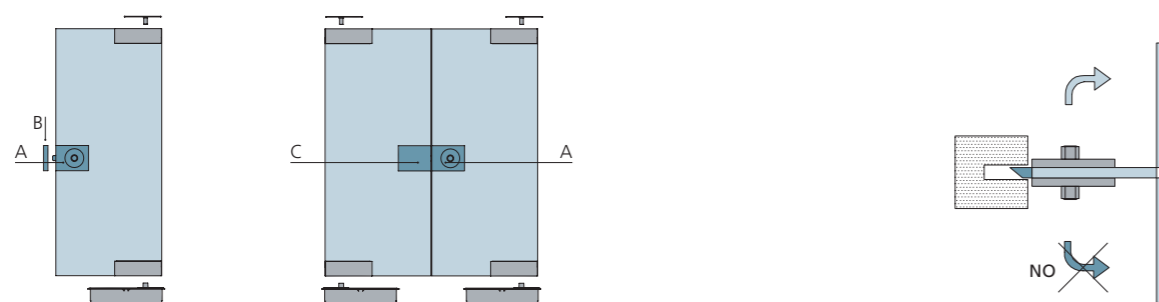

A	B	C	D	E	F	G	H
art. 510/512	art. 313C	art. 511/513	-	-	-	-	-

art. 510



Serratura con scrocco e pomoli  
Spring latch lock with knobs



argento/silver	bronzo/bronze	oro/gold	nero/black	verniciato/powder	cromato/chrome	oro luc./bright gold	crom.sat/chro. mat
N-0510-A-SP	N-0510-B-SP	N-0510-O-SP	N-0510-N-SP	N-0510-V-SP	N-0510-C-SP	N-0510-L-SP	N-0510-I-SP
N-0510-A-TI	N-0510-B-TI	N-0510-O-TI	N-0510-N-TI	N-0510-V-TI	N-0510-C-TI	N-0510-L-TI	N-0510-I-TI

art. 511



Contro per Art. 510  
Lock keeper for Art. 510



argento/silver	bronzo/bronze	oro/gold	nero/black	verniciato/powder	cromato/chrome	oro luc./bright gold	crom.sat/chro. mat
N-0511-A	N-0511-B	N-0511-O	N-0511-N	N-0511-V	N-0511-C	N-0511-L	N-0511-I

art. 512



Serratura con scrocco e maniglie  
Spring latch lock with handles



argento/silver	bronzo/bronze	oro/gold	nero/black	verniciato/powder	cromato/chrome	oro luc./bright gold	crom.sat/chro. mat
N-0512-A-SP	N-0512-B-SP	N-0512-O-SP	N-0512-N-SP	N-0512-V-SP	N-0512-C-SP	N-0512-L-SP	N-0512-I-SP
N-0512-A-TI	N-0512-B-TI	N-0512-O-TI	N-0512-N-TI	N-0512-V-TI	N-0512-C-TI	N-0512-L-TI	N-0512-I-TI

art. 513



Contro per Art. 512  
Lock keeper for Art. 512



argento/silver	bronzo/bronze	oro/gold	nero/black	verniciato/powder	cromato/chrome	oro luc./bright gold	crom.sat/chro. mat
N-0513-A	N-0513-B	N-0513-O	N-0513-N	N-0513-V	N-0513-C	N-0513-L	N-0513-I

art. 313C



Battuta a 90° per Art. 510/512  
90° strike plate for Art. 510/512

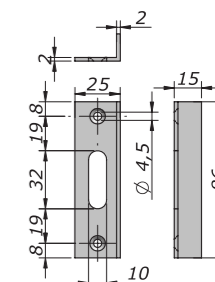

argento/silver	bronzo/bronze	oro/gold	nero/black	verniciato/powder	cromato/chrome	oro luc./bright gold	crom.sat/chro. mat
N-313C-A	N-313C-B	N-313C-O	N-313C-N	N-313C-V	N-313C-C	N-313C-L	N-313C-I

legenda / legenda

portata / load	spessori / thickness
-	8 - 12

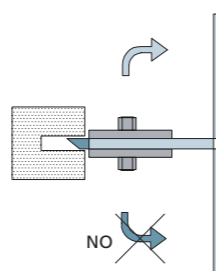
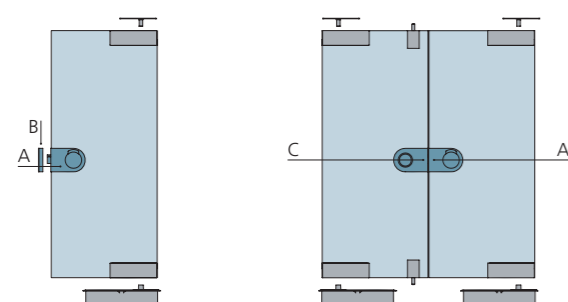

A	B	C	D	E	F	G	H
art. 20/213	art. 313D	art. 21/214	-	-	-	-	-

art. 20

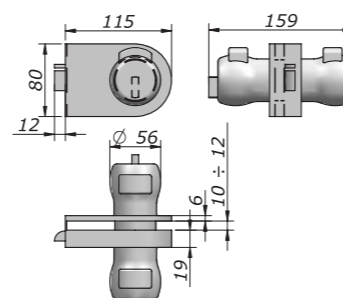
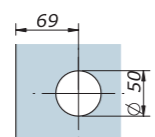

Serratura premi apri Meroni  
Lock "Premi apri Meroni"

argento/silver	bronzo/bronze	oro/gold	nero/black	verniciato/powder	cromato/chrome	oro luc./bright gold	crom.sat/chro. mat
N-0020-A	-	-	N-0020-N	-	N-0020-C	-	N-0020-I

art. 21

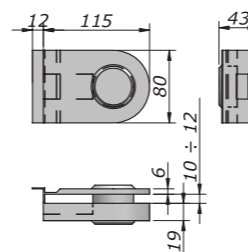
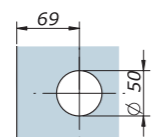

Contro per premi apri Art. 20  
Lock keeper for Art. 20

argento/silver	bronzo/bronze	oro/gold	nero/black	verniciato/powder	cromato/chrome	oro luc./bright gold	crom.sat/chro. mat
N-0021-A	-	-	N-0021-N	-	N-0021-C	-	N-0021-I

art. 213

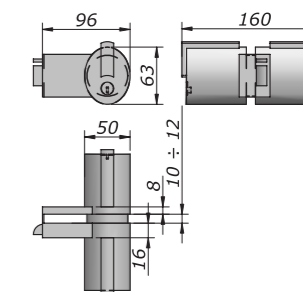
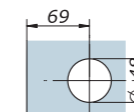

Serratura "Forma Meroni"  
Lock "Forma Meroni"

argento/silver	bronzo/bronze	oro/gold	nero/black	verniciato/powder	cromato/chrome	oro luc./bright gold	crom.sat/chro. mat
N-0213-A	-	-	N-0213-N	-	N-0213-C	-	N-0213-I

art. 214

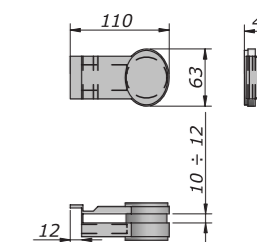
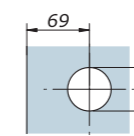
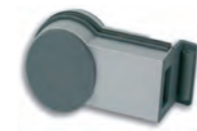

Contro per Art. 213  
Lock keeper for Art. 213

argento/silver	bronzo/bronze	oro/gold	nero/black	verniciato/powder	cromato/chrome	oro luc./bright gold	crom.sat/chro. mat
N-0214-A	-	-	N-0214-N	-	N-0214-C	-	N-0214-I

art. 313D

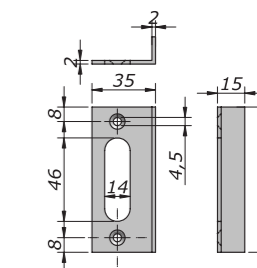

Battuta a 90° per Art. 20 e Art. 213  
90° strike plate for Art. 20/213

argento/silver	bronzo/bronze	oro/gold	nero/black	verniciato/powder	cromato/chrome	oro luc./bright gold	crom.sat/chro. mat
N-313D-A	-	-	N-313D-N	-	N-313D-C	-	N-313D-I



locks with roller mechanism

serrature con meccanismo a rullo

**OXIDAL**  
your\_project\_partner



legenda / legenda

portata / load	spessori / thickness
-	8 - 12

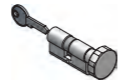
**C. P.**  
  
 Cilindro con chiave e pomolo Cod. CP  
 Cylinder with key and knob Cod. CP

**C. U.**  
  
 Cilindro con chiave unificata Cod. CU  
 Cylinder with same key Cod. CU

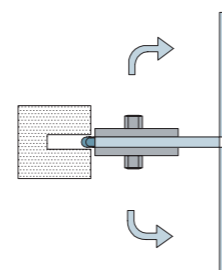
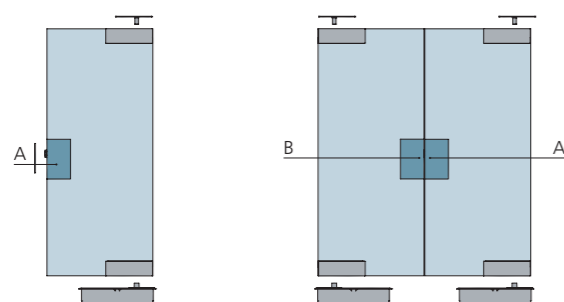

A	B	C	D	E	F	G	H
art. 230/232	art. 231	-	-	-	-	-	-

art. 230

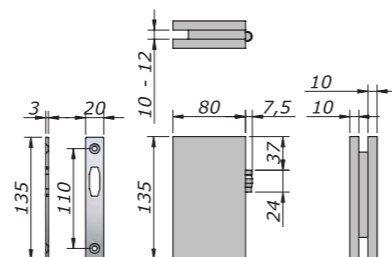
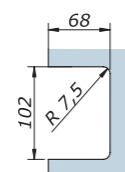

Serratura con rullo senza cilindro  
Lock with roller without cylinder

argento/silver	bronzo/bronze	oro/gold	nero/black	verniciato/powder	cromato/chrome	oro luc./bright gold	crom.sat/chro. mat
N-0230-A	N-0230-B	N-0230-O	N-0230-N	N-0230-V	N-0230-C	N-0230-L	N-0230-I

art. 231

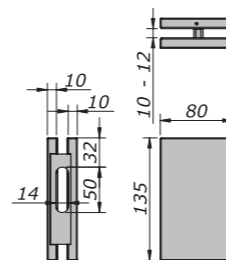
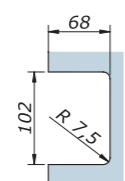

Contro per Art. 232  
Lock keeper for Art. 230/232

argento/silver	bronzo/bronze	oro/gold	nero/black	verniciato/powder	cromato/chrome	oro luc./bright gold	crom.sat/chro. mat
N-0231-A	-	-	N-0231-N	-	N-0231-C	-	N-0231-I

art. 232

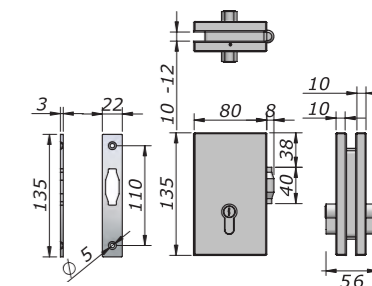
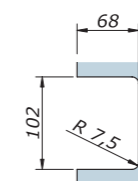

Serratura con rullo e cilindro  
Lock with roller and cylinder

argento/silver	bronzo/bronze	oro/gold	nero/black	verniciato/powder	cromato/chrome	oro luc./bright gold	crom.sat/chro. mat
N-0232-A	-	-	N-0232-N	-	N-0232-C	-	N-0232-I

art. 233

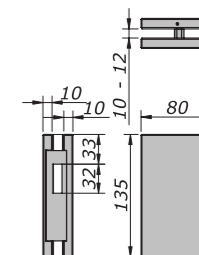
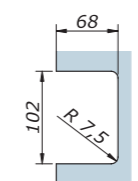

Contro per Art. 232A e Art. 230  
Catch for Art. 232A e Art. 230

argento/silver	bronzo/bronze	oro/gold	nero/black	verniciato/powder	cromato/chrome	oro luc./bright gold	crom.sat/chro. mat
N-0233-A	-	-	N-0233-N	-	N-0233-C	-	N-0233-I



pag. 148\_Intro  
pag. 150\_Incontri e bocchette  
elettrici  
pag. 154\_Serrature Elettriche

serrature e incontri elettrici

**OXIDAL**  
your\_project\_partner

electric locks and strikes

pag. 148\_Intro  
pag. 150\_Electric lock keepers  
and strikers  
pag. 154\_Electric locks





legenda / legenda



■ Trasformatore per corrente 12 V = 8 A  
Transformer for current 12 V = 8 A

— Filo corrente elettrica  
Electric cable

280 Serratura a scrocco  
Latch lock

281 Controllo elettrico per art. 280  
Electric catch for art. 280

282 Fascia di copertura filo elettrico  
Cover rails for electric cables

283 Bocchetta elettrica a muro  
Electric strike to wall

270 Serratura elettrica diretta  
Direct electric lock

271 Contro per art. 270  
Catch for art. 270

Serrature elettriche:

- Esistono due diverse soluzioni di meccanismi elettrici:
  - **Serrature elettriche dirette (Art. 270)**  
La parte elettrica è sulla serratura a scrocco, l'incontro è una semplice battuta (alimentazione elettrica dal lato serratura).
  - **Incontro elettrico (Art. 281/281A/283)**  
La parte elettrica è nell'incontro e occorre l'utilizzo di apposite serrature a scrocco (alimentazione elettrica dal lato incontro).
- È sempre consigliato l'utilizzo di incontri elettrici in quanto il collegamento elettrico, essendo sul fisso o semi fisso, subisce minori sollecitazioni e quindi si ha un minor rischio di malfunzionamento.
- **Tutte le serrature e incontri elettrici funzionano con corrente alternata 12 V.**

Electric locks:

- There are two different solutions for electric mechanisms:
  - **Direct electric locks (Art. 270)**  
The electric part is in the latch lock, the lock keeper is a simple strike (electrical power from the lock side).
  - **Electric strikes (Art. 281/281A/283)**  
The electric part is in the lock keeper. It must be used an appropriate latch lock (electrical power from the lock keeper side).
- It is always advised to use electric strikes because being the electric connection on the fixed or semi-fixed glass, it will suffer minor stress and therefore has a lower risk of malfunction.
- **All the electric locks and strikes work with alternate current 12 V.**

- Gli incontri elettrici forniti prevedono leva di sblocco a giorno e sganciamento permanente dopo l'impulso elettrico (senza antiripetitore).
- Le serrature elettriche fornite prevedono lo sganciamento permanente dopo l'impulso elettrico (senza antiripetitore) e non prevedono lo sblocco a giorno.
- La modalità di apertura (pulsante, codice, carte magnetiche ecc.) è stabilita in base ai dispositivi previsti nell'impianto elettrico ed alle necessità del cliente. La modalità di apertura scelta non è influente sulla tipologia di meccanismo elettrico.
- Le serrature sono fornite di cilindro con pomolino che permette l'uscita dall'interno senza chiave ed in mancanza di elettricità.

- The electric strike supplied provide daily release lever and permanent release upon electrical contact (without anti-repeater).
- The electric locks supplied provide permanent release upon electrical contact (without anti-repeater) and do not provide daily release level.
- The opening mode (button, code, magnetic cards, etc.) is determined by the devices provided in the electrical system and customer demand. The opening mode choice is not influential on the type of electric mechanism and accessories we supply.
- The locks are supplied with cylinder with knob that allow the exit from inside without key in absence of electricity.

legenda / legenda

portata / load	spessori / thickness
-	8 - 12

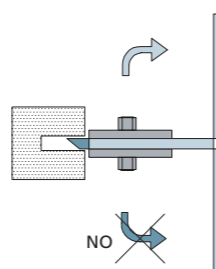
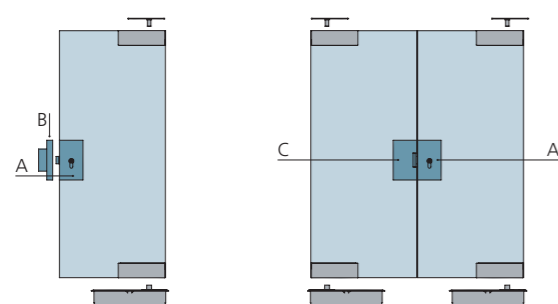

A	B	C	D	E	F	G	H
art. 280A	art. 283	art. 281A	-	-	-	-	-

art. 280A

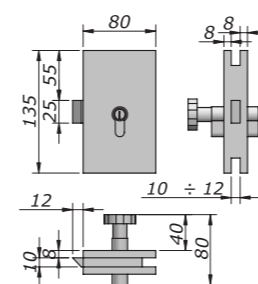
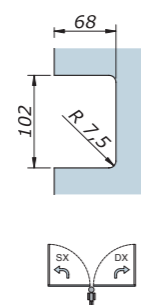

Serratura scrocco piccola per incontri elettrici  
Small spring latch lock for electric strike

argento/silver	bronzo/bronze	oro/gold	nero/black	verniciato/powder	cromato/chrome	oro luc./bright gold	crom.sat/chro. mat
N-280A-A-DX	N-280A-B-DX	N-280A-O-DX	N-280A-N-DX	N-280A-V-DX	N-280A-C-DX	N-280A-L-DX	N-280A-I-DX
N-280A-A-SX	N-280A-B-SX	N-280A-O-SX	N-280A-N-SX	N-280A-V-SX	N-280A-C-SX	N-280A-L-SX	N-280A-I-SX

art. 281A

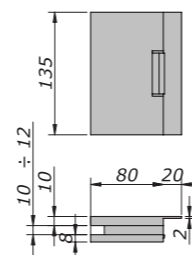
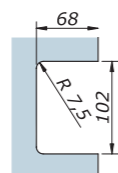

Contro per Art. 280A (potenza richiesta 12V)  
Electric lock keeper for Art. 280A

argento/silver	bronzo/bronze	oro/gold	nero/black	verniciato/powder	cromato/chrome	oro luc./bright gold	crom.sat/chro. mat
N-281A-A	N-281A-B	N-281A-O	N-281A-N	N-281A-V	N-281A-C	N-281A-L	N-281A-I

art. 283

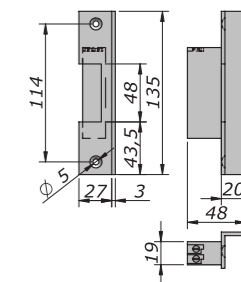

Bocchetta elettrica a muro con battuta (potenza richiesta 12V)  
Electric striker with stop (requested power 12V)

argento/silver	bronzo/bronze	oro/gold	nero/black	verniciato/powder	cromato/chrome	oro luc./bright gold	crom.sat/chro. mat
N-0283-A	N-0283-B	N-0283-O	N-0283-N	N-0283-V	N-0283-C	N-0283-L	N-0283-I



legenda / legenda

portata / load	spessori / thickness
-	8 - 12

NB:  
specificare lunghezza in caso d'ordine  
length has to be specified while ordering

oltre 1000 mm realizzabili su richiesta  
over 1000 mm on request

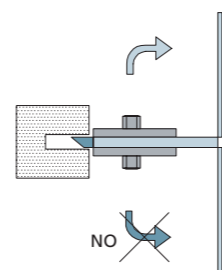
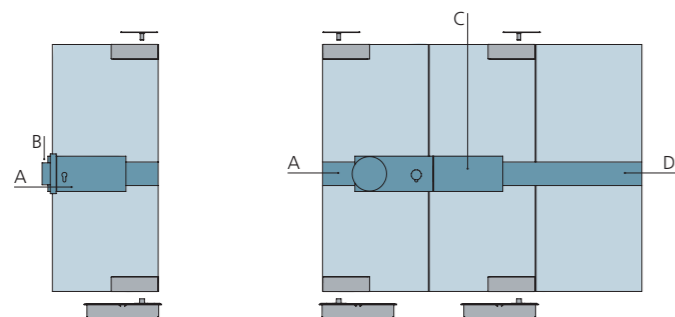

A	B	C	D	E	F	G	H
art. 280	art. 283	art. 281	art.282	-	-	-	-

art. 280



Serratura scrocco e fasce  
Spring latch lock with cable cover

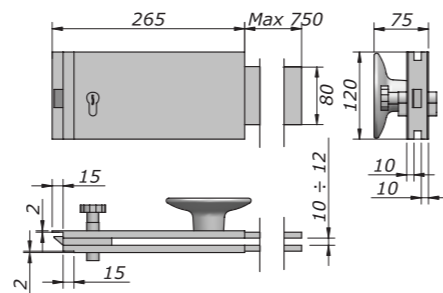
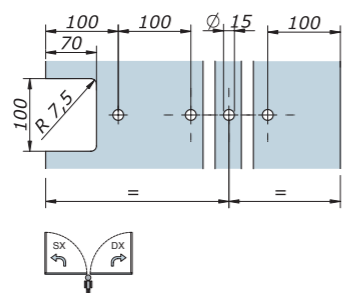

argento/silver	bronzo/bronze	oro/gold	nero/black	verniciato/powder	cromato/chrome	oro luc./bright gold	crom.sat/chro. mat
N-0280-A-DX	N-0280-B-DX	N-0280-O-DX	N-0280-N-DX	N-0280-V-DX	N-0280-C-DX	N-0280-L-DX	N-0280-I-DX
N-0280-A-SX	N-0280-B-SX	N-0280-O-SX	N-0280-N-SX	N-0280-V-SX	N-0280-C-SX	N-0280-L-SX	N-0280-I-SX

art. 281



Contro elettrico per Art. 280  
Electric lock keeper for Art. 280

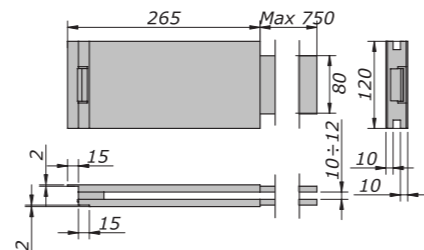
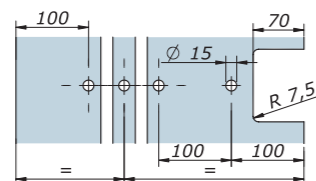

argento/silver	bronzo/bronze	oro/gold	nero/black	verniciato/powder	cromato/chrome	oro luc./bright gold	crom.sat/chro. mat
N-0281-A	N-0281-B	N-0281-O	N-0281-N	N-0281-V	N-0281-C	N-0281-L	N-0281-I

art. 282

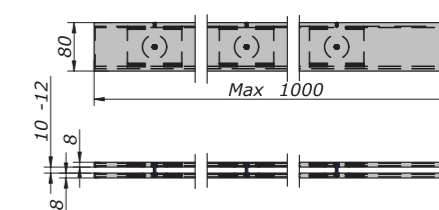
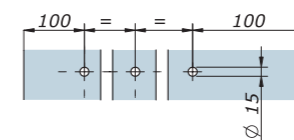

Fasce fisse per serrature elettriche  
Cable cover for electric lock

argento/silver	bronzo/bronze	oro/gold	nero/black	verniciato/powder	cromato/chrome	oro luc./bright gold	crom.sat/chro. mat
N-0282-A	N-0282-B	N-0282-O	N-0282-N	N-0282-V	N-0282-C	N-0282-L	N-0282-I

art. 283

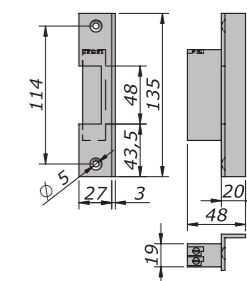

Bocchetta elettrica a muro con battuta (potenza richiesta 12V)  
Electric striker with stop (requested power 12V)

argento/silver	bronzo/bronze	oro/gold	nero/black	verniciato/powder	cromato/chrome	oro luc./bright gold	crom.sat/chro. mat
N-0283-A	N-0283-B	N-0283-O	N-0283-N	N-0283-V	N-0283-C	N-0283-L	N-0283-I



legenda / legenda

portata / load	spessori / thickness
-	8 - 12

NB:  
specificare lunghezza in caso d'ordine  
length has to be specified while ordering

oltre 1000 mm realizzabili su richiesta  
over 1000 mm on request

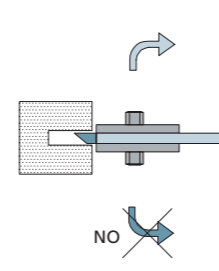
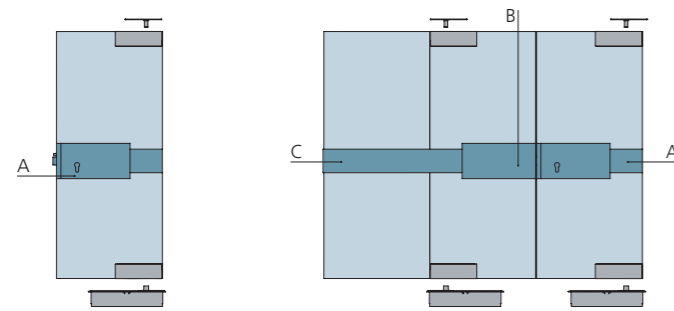

A	B	C	D	E	F	G	H
art. 270	art. 271	art. 282	-	-	-	-	-

art. 270

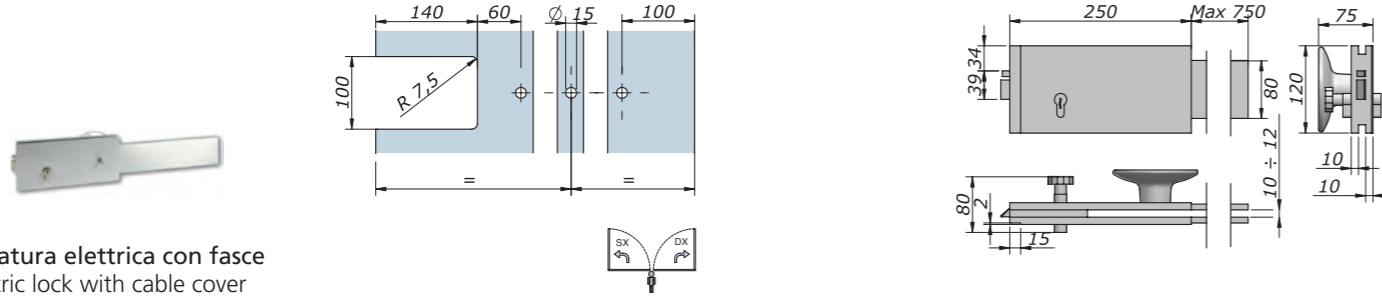

Serratura elettrica con fasce  
Electric lock with cable cover

argento/silver	bronzo/bronze	oro/gold	nero/black	verniciato/powder	cromato/chrome	oro luc./bright gold	crom.sat/chro. mat
N-0270-A-DX	N-0270-B-DX	N-0270-O-DX	N-0270-N-DX	N-0270-V-DX	N-0270-C-DX	N-0270-L-DX	N-0270-I-DX
N-0270-A-SX	N-0270-B-SX	N-0270-O-SX	N-0270-N-SX	N-0270-V-SX	N-0270-C-SX	N-0270-L-SX	N-0270-I-SX

art. 271

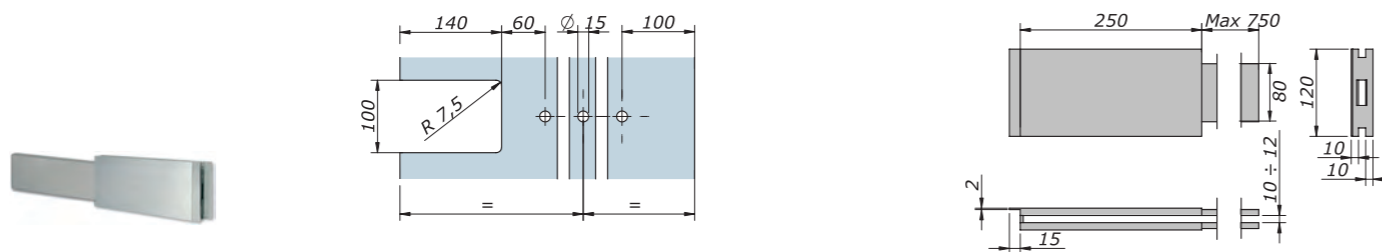

Contro per Art. 270 con fasce  
Lock keeper for Art. 270 with cable cover

argento/silver	bronzo/bronze	oro/gold	nero/black	verniciato/powder	cromato/chrome	oro luc./bright gold	crom.sat/chro. mat
N-0271-A	N-0271-B	N-0271-O	N-0271-N	N-0271-V	N-0271-C	N-0271-L	N-0271-I

art. 282

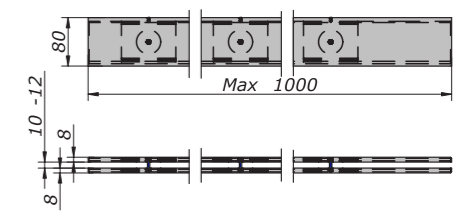
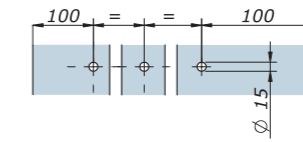

Fasce fisse per serrature elettriche  
Cable cover for electric lock

argento/silver	bronzo/bronze	oro/gold	nero/black	verniciato/powder	cromato/chrome	oro luc./bright gold	crom.sat/chro. mat
N-0282-A	N-0282-B	N-0282-O	N-0282-N	N-0282-V	N-0282-C	N-0282-L	N-0282-I

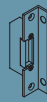
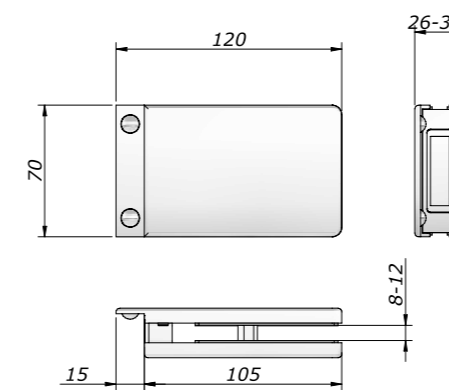

antipánico

**OXIDAL**  
your\_project\_partner

panic devices



### Antipanico - porte singole

Panic device - single doors

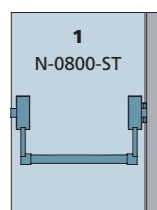

Antipanico orizzontale standard

Standard horizontal panic device

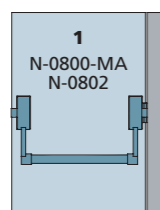

Antipanico orizzontale standard con maniglia esterna

Standard horizontal panic device with external handle

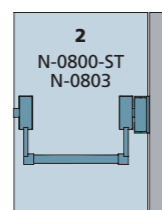

Antipanico orizzontale con bocchetta elettrica

Horizontal panic device with electric strike

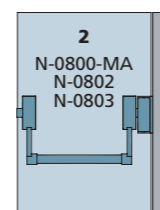

Antipanico orizzontale con bocchetta elettrica e maniglia esterna

Horizontal panic device with electric strike and external handle

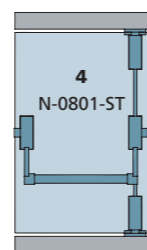

Antipanico verticale standard

Standard vertical panic device

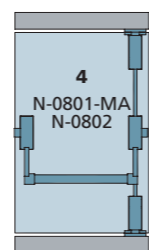

Antipanico verticale standard con maniglia esterna

Standard vertical panic device with external handle

### Antipanico - porte doppie

Panic device - double doors

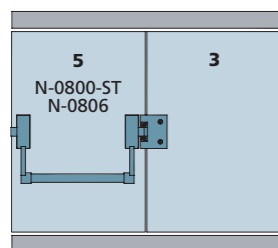

Antipanico orizzontale standard con contro a vetro

Standard horizontal panic device with strike on glass

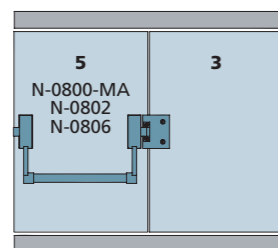

Antipanico orizzontale standard con maniglia esterna e contro a vetro

Standard horizontal panic device with external handle and strike on glass

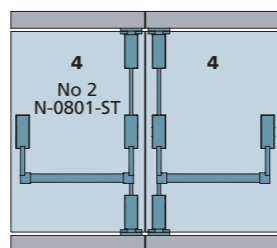

Antipanico verticale standard per doppia porta

Standard vertical panic device for double door

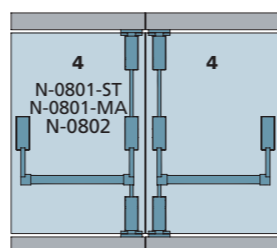

Antipanico verticale standard per doppia porta con maniglia esterna

Standard vertical panic device for double door with external handle

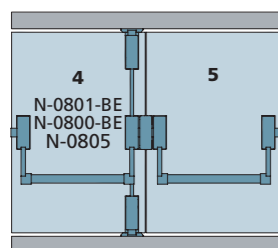

Antipanico verticale per doppia porta con bocchetta elettrica

Vertical panic device for double door with electric strike

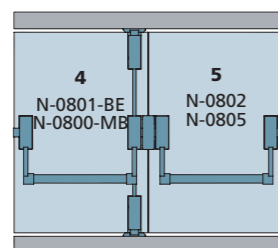

Antipanico verticale per doppia porta con bocchetta elettrica e maniglia esterna

Vertical panic device for double door with electric strike and external handle

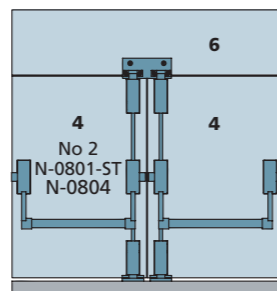

Antipanico verticale standard per doppia porta con sopra luce

Standard vertical panic device for double door with top glass

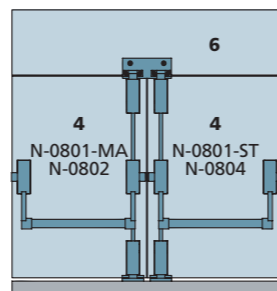

Antipanico verticale standard per doppia porta maniglia esterna e sopra luce

Standard vertical panic device for double door with external handle and top glass

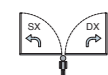

### Antipanico:

- Nelle porte doppie è sconsigliato l'utilizzo di maniglioni antipanico orizzontali salvo se con incontro elettrico.
- Non è possibile utilizzare bocchette o incontri elettrici con maniglioni antipanico verticali.

### Panic Device:

- In double doors it is suggested not to use the horizontal panic device, unless with electric catch.
- It's not possible to use electric catch with vertical panic device.

### Antipanico - Push-bar

Panic device - Push-bar

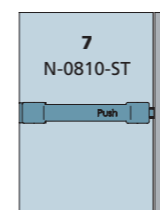

Antipanico orizzontale Push-bar

Push-bar horizontal panic device

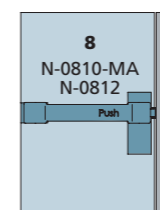

Antipanico orizzontale Push-bar con maniglia esterna

Push-bar horizontal panic device with external handle

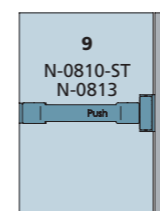

Antipanico orizzontale Push-bar con bocchetta elettrica

Push-bar horizontal panic device with electric strike

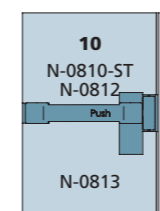

Antipanico orizzontale Push-bar con maniglia esterna e bocchetta elettrica

Push-bar horizontal panic device with external handle and electric strike

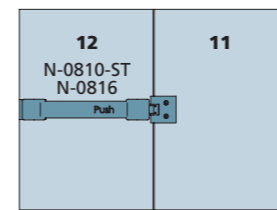

Antipanico orizzontale Push-bar con contro a vetro

Push-bar horizontal panic device with strike on glass

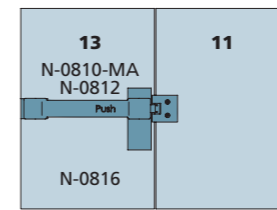

Antipanico orizzontale Push-bar con maniglia esterna e contro a vetro

Push-bar horizontal panic device with strike on glass

### Tacche vetri

Glass cut out

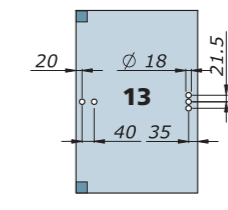
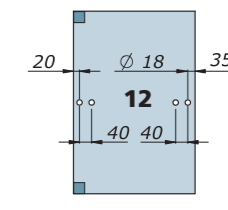
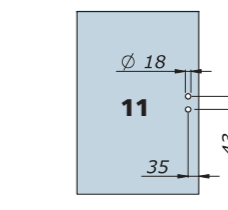
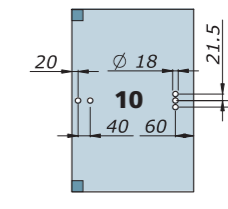
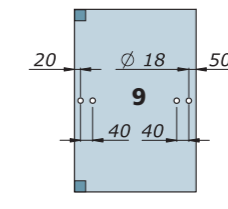
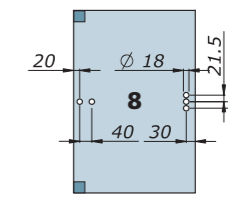
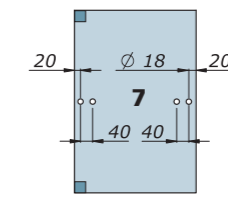
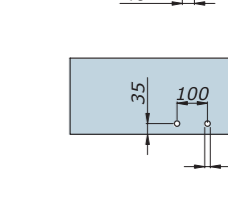
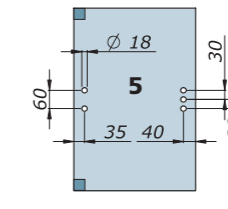
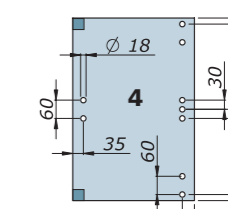
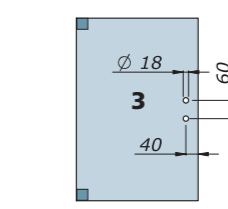
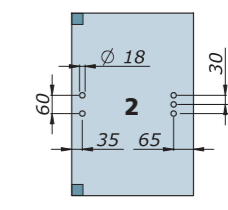
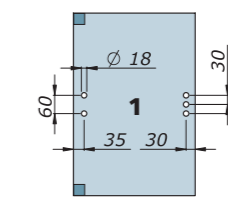

art. 800



ST: standard / standard  
MA: con maniglia / with handle  
BE: con bocchetta elettrica  
with electric striker  
MB: con maniglia e bocchetta  
elettrica / with handle  
and electric striker

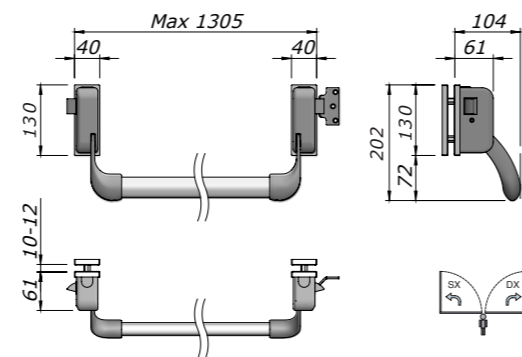

Antipanico orizzontale  
Horizontal panic device

argento/silver	cromo/chrome	cromato satinato/chrome mat
N-0800-A-ST	N-0800-C-ST	N-0800-I-ST
N-0800-A-MA	N-0800-C-MA	N-0800-I-MA
N-0800-A-BE-DX/SX	N-0800-C-BE-DX/SX	N-0800-I-BE-DX/SX
N-0800-A-MB-DX/SX	N-0800-C-MB-DX/SX	N-0800-I-MB-DX/SX

art. 801

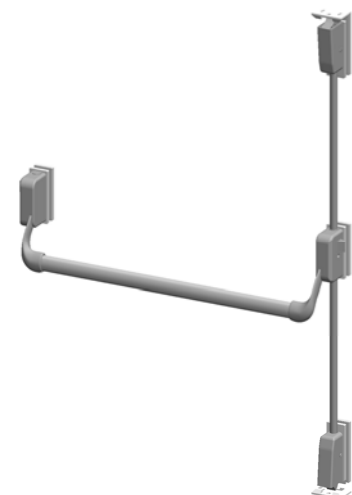

ST: standard / standard  
MA: con maniglia / with handle  
BE: con bocchetta elettrica  
with electric striker

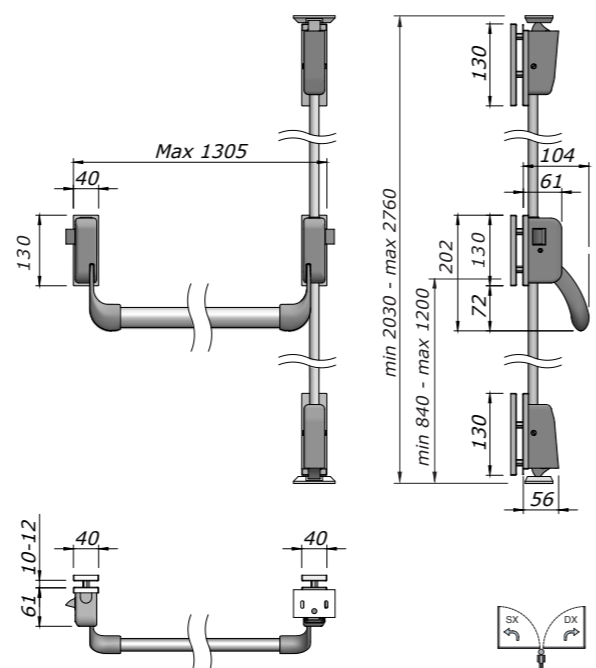

Antipanico verticale  
Vertical panic device

argento/silver	cromo/chrome	cromato satinato/chrome mat
N-0801-A-ST	N-0801-C-ST	N-0801-I-ST
N-0801-A-MA	N-0801-C-MA	N-0801-I-MA
N-0801-A-BE-DX/SX	N-0801-C-BE-DX/SX	N-0801-I-BE-DX/SX

art. 802

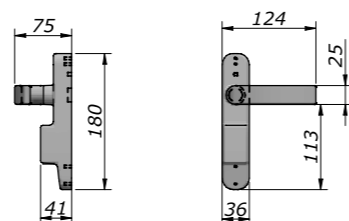
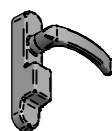

Maniglia esterna  
External handle

tutto argento/all silver	cromo/chrome	cromato satinato/chrome mat
N-0802-A	N-0802-C	N-0802-I

art. 803

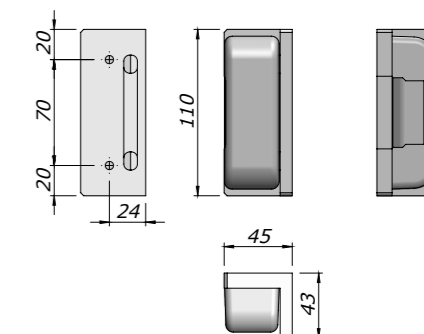
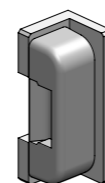

Bocchetta elettrica a muro  
Wall electric strike

tutto argento/all silver	cromo/chrome	cromato satinato/chrome mat
N-0803-A	N-0803-C	N-0803-I

art. 804

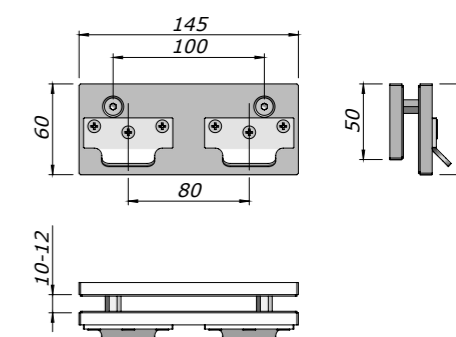
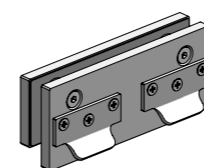

Piastra per aggancio a sopraluce  
Over panel strike plate

tutto argento/all silver	cromo/chrome	cromato satinato/chrome mat
N-0804-A	N-0804-C	N-0804-I

art. 805

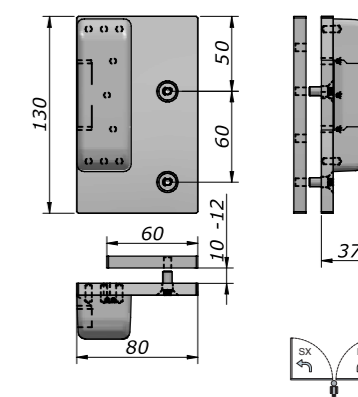

Contro elettrico a vetro  
Glass electric strike

tutto argento/all silver	cromo/chrome	cromato satinato/chrome mat
N-0805-A-DX/SX	N-0805-C-DX/SX	N-0805-I-DX/SX

art. 806

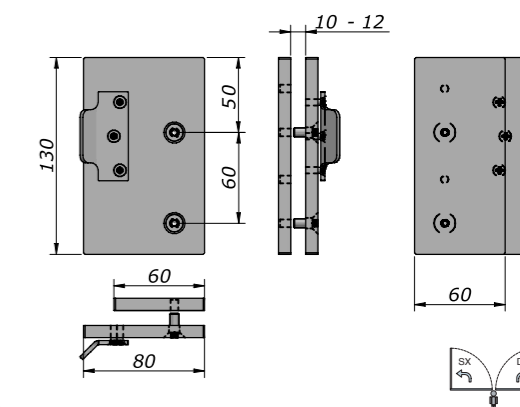
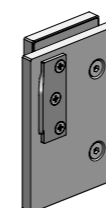

Conto a vetro per art. 800  
Glass strike for art. 800

tutto argento/all silver	cromo/chrome	cromato satinato/chrome mat
N-0806-A-DX/SX	N-0806-C-DX/SX	N-0806-I-DX/SX

art. 810



ST: standard / standard  
MA: con maniglia / with handle

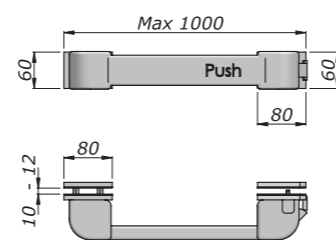

Antipanico orizzontale Push-bar  
Push-bar horizontal panic device

tutto argento/all silver	nero barra rosso/black with red bar	tutto cromo/all chrome	arg. piastre cr. sat./silver chro. mat plate
N-0810-A-ST	N-0810-N-ST	N-0810-C-ST	N-0810-I-ST
N-0810-A-MA	N-0810-N-MA	N-0810-C-MA	N-0810-I-MA

art. 812



Maniglia esterna per Art. 810  
External handle for Art. 810

tutto argento/all silver	nero barra rosso/black with red bar	tutto cromo/all chrome	arg. piastre cr. sat./silver chro. mat plate
N-0812-A	N-0812-N	N-0812-C	N-0812-I

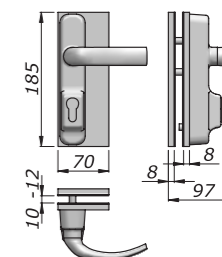

art. 816



Contro a vetro per art. 810  
Glass strike for art. 810

tutto argento/all silver	nero barra rosso/black with red bar	tutto cromo/all chrome	arg. piastre cr. sat./silver chro. mat plate
N-0816-A	N-0816-N	N-0816-C	N-0816-I

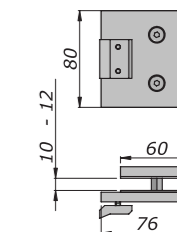





per ante semi-fisse

Catenacci, serrature e sistemi  
di ritegno di vario tipo  
per ante semifisse.

**OXIDAL**  
your\_project\_partner

for semi-fixed doors

*Bolts, locks and blocking  
systems of various types  
for semi-fixed doors.*



legenda / legenda

portata / load	spessori / thickness
-	8 - 12

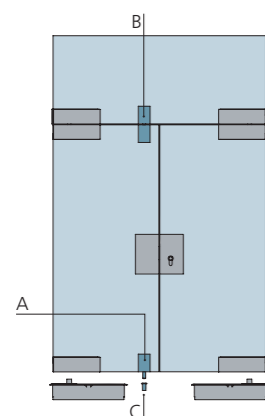

A	B	C	D	E	F	G	H
art. 290/292	art. 291/293	art. 316	-	-	-	-	-

art. 290

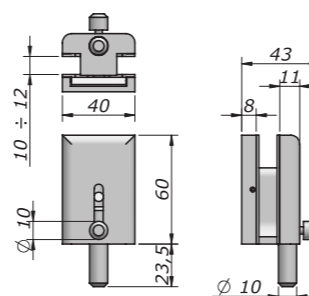
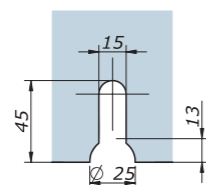

Catenaccio  
Small bolt

argento/silver	bronzo/bronze	oro/gold	nero/black	verniciato/powder	cromato/chrome	oro luc./bright gold	crom.sat/chro. mat
N-0290-A	N-0290-B	N-0290-O	N-0290-N	N-0290-V	N-0290-C	N-0290-L	N-0290-I

art. 291

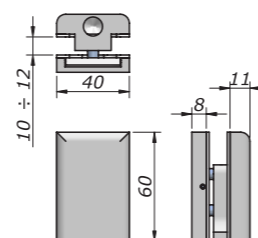
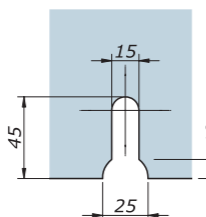

Contro per Art. 290  
Lock keeper for Art. 290

argento/silver	bronzo/bronze	oro/gold	nero/black	verniciato/powder	cromato/chrome	oro luc./bright gold	crom.sat/chro. mat
N-0291-A	N-0291-B	N-0291-O	N-0291-N	N-0291-V	N-0291-C	N-0291-L	N-0291-I

art. 292

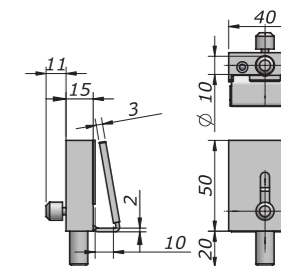

Catenaccio a pressione  
Small bolt without cut out

argento/silver	bronzo/bronze	oro/gold	nero/black	verniciato/powder	cromato/chrome	oro luc./bright gold	crom.sat/chro. mat
N-0292-A	N-0292-B	N-0292-O	N-0292-N	N-0292-V	N-0292-C	N-0292-L	N-0292-I

art. 293

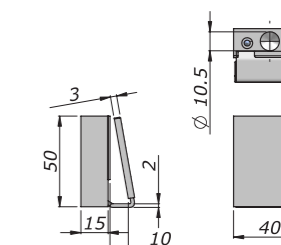
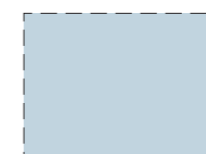

Contro per Art. 292  
Lock keeper for Art. 292

argento/silver	bronzo/bronze	oro/gold	nero/black	verniciato/powder	cromato/chrome	oro luc./bright gold	crom.sat/chro. mat
N-0293-A	N-0293-B	N-0293-O	N-0293-N	N-0293-V	N-0293-C	N-0293-L	N-0293-I

art. 316

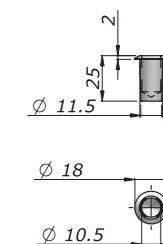

Bussola a pavimento piccola  
Small floor bush

argento/silver	bronzo/bronze	oro/gold	nero/black	verniciato/powder	cromato/chrome	oro luc./bright gold	crom.sat/chro. mat
N-0316-A	N-0316-B	N-0316-O	N-0316-N	N-0316-V	N-0316-C	N-0316-L	N-0316-I



legenda / legenda

portata / load	spessori / thickness
-	8 - 12

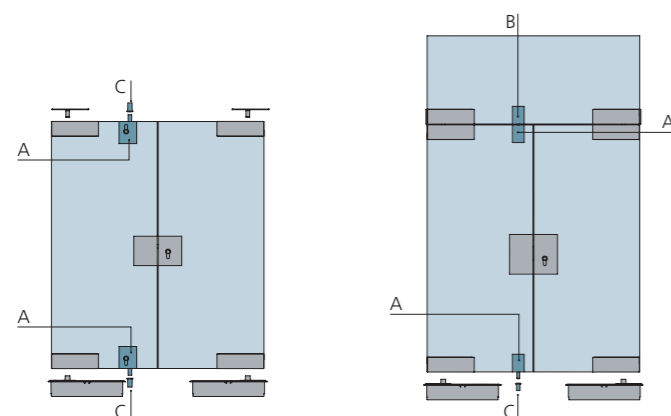

A	B	C	D	E	F	G	H
art. 240/242	art. 241	art. 314	-	-	-	-	-

art. 240



Serratura piccola  
Small lock

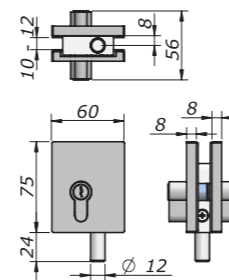
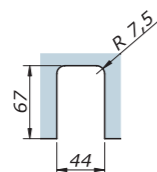

argento/silver	bronzo/bronze	oro/gold	nero/black	verniciato/powder	cromato/chrome	oro luc./bright gold	crom.sat/chro. mat
N-0240-A	N-0240-B	N-0240-O	N-0240-N	N-0240-V	N-0240-C	N-0240-L	N-0240-I

art. 241



Contro per Art. 240/242  
Lock keeper for Art. 240/242

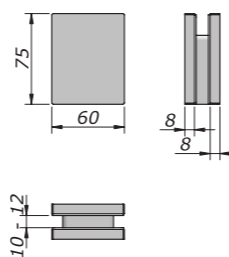
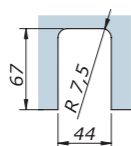

argento/silver	bronzo/bronze	oro/gold	nero/black	verniciato/powder	cromato/chrome	oro luc./bright gold	crom.sat/chro. mat
N-0241-A	N-0241-B	N-0241-O	N-0241-N	N-0241-V	N-0241-C	N-0241-L	N-0241-I

art. 242

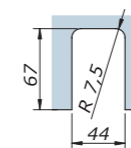

Catenaccio con pomolo  
Big bolt with knob

argento/silver	bronzo/bronze	oro/gold	nero/black	verniciato/powder	cromato/chrome	oro luc./bright gold	crom.sat/chro. mat
N-0242-A	N-0242-B	N-0242-O	N-0242-N	N-0242-V	N-0242-C	N-0242-L	N-0242-I

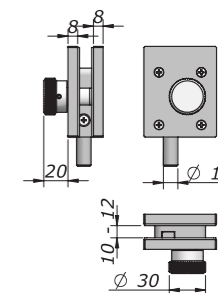

art. 314



Bussola a pavimento grande  
Big floor bush

argento/silver	bronzo/bronze	oro/gold	nero/black	verniciato/powder	cromato/chrome	oro luc./bright gold	crom.sat/chro. mat
N-0314-A	N-0314-B	N-0314-O	N-0314-N	N-0314-V	N-0314-C	N-0314-L	N-0314-I

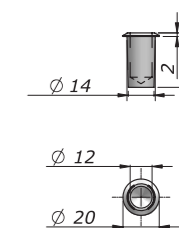

legenda / legenda

portata / load	spessori / thickness
-	8 - 20

**C. P.**  
Cilindro con chiave e pomolo Cod. CP  
Cylinder with key and knob Cod. CP

**C. U.**  
Cilindro con chiave unificata Cod. CU  
Cylinder with same key Cod. CU

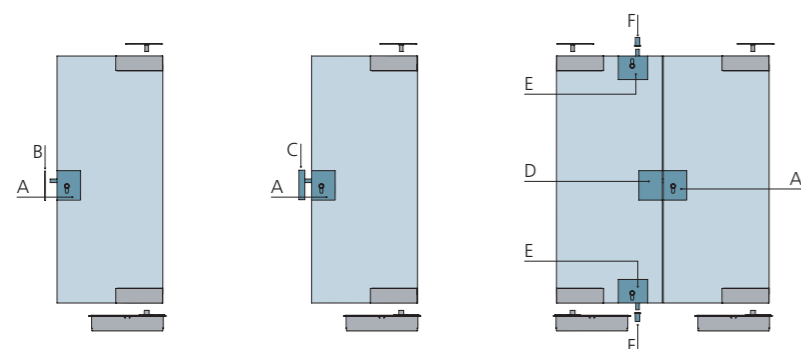

A	B	C	D	E	F	G	H
art. 220	art. 312A	art. 313A	art. 221	art. 222	art. 314	-	-

art. 220



Serratura verticale  
Vertical lock

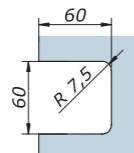

\*  
N-0220-A: max 12 mm  
N-0220-A-14: max 14 mm  
N-0220-A-18: max 18 mm  
N-0220-A-20: max 20 mm

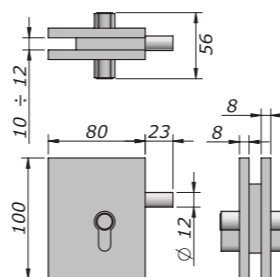

argento/silver	bronzo/bronze	oro/gold	nero/black	verniciato/powder	cromato/chrome	oro luc./bright gold	crom.sat/chro. mat
N-0220-A *	N-0220-B	N-0220-O	N-0220-N	N-0220-V	N-0220-C	N-0220-L	N-0220-I
N-0220-A-14 *	-	-	-	-	N-0220-C-14	-	N-0220-I-14
N-0220-A-18 *	-	-	-	-	N-0220-C-18	-	N-0220-I-18
N-0220-A-20 *	-	-	-	-	N-0220-C-20	-	N-0220-I-20

art. 221



Contro per Art. 220/222  
Lock keeper for Art. 220/222

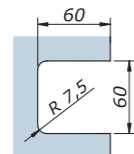

\*  
N-0221-A: max 12 mm  
N-0221-A-14: max 14 mm  
N-0221-A-18: max 18 mm  
N-0221-A-20: max 20 mm

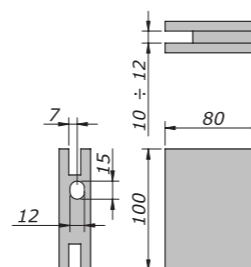

argento/silver	bronzo/bronze	oro/gold	nero/black	verniciato/powder	cromato/chrome	oro luc./bright gold	crom.sat/chro. mat
N-0221-A *	N-0221-B	N-0221-O	N-0221-N	N-0221-V	N-0221-C	N-0221-L	N-0221-I
N-0221-A-14 *	-	-	-	-	N-0221-C-14	-	N-0221-I-14
N-0221-A-18 *	-	-	-	-	N-0221-C-18	-	N-0221-I-18
N-0221-A-20 *	-	-	-	-	N-0221-C-20	-	N-0221-I-20

art. 222

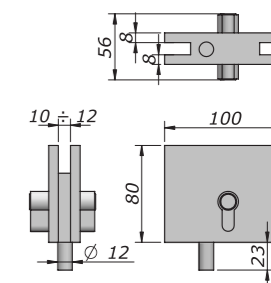
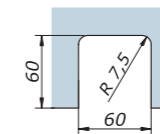

Serratura orizzontale  
Horizontal lock

argento/silver	bronzo/bronze	oro/gold	nero/black	verniciato/powder	cromato/chrome	oro luc./bright gold	crom.sat/chro. mat
N-0222-A	N-0222-B	N-0222-O	N-0222-N	N-0222-V	N-0222-C	N-0222-L	N-0222-I

art. 312A

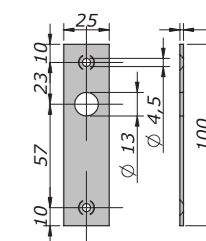

Bocchetta a 180° per Art. 220/222/900  
180° strike plate for Art. 220/222/900

argento/silver	bronzo/bronze	oro/gold	nero/black	verniciato/powder	cromato/chrome	oro luc./bright gold	crom.sat/chro. mat
N-312A-A	N-312A-B	N-312A-O	N-312A-N	N-312A-V	N-312A-C	N-312A-L	N-312A-I

art. 313A

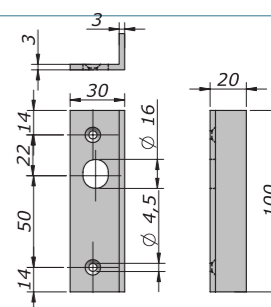

Battuta a 90° per Art. 220/222  
90° strike plate for Art. 220/222

argento/silver	bronzo/bronze	oro/gold	nero/black	verniciato/powder	cromato/chrome	oro luc./bright gold	crom.sat/chro. mat
N-313A-A-DX	N-313A-B-DX	N-313A-O-DX	N-313A-N-DX	N-313A-V-DX	N-313A-C-DX	N-313A-L-DX	N-313A-I-DX
N-313A-A-SX	N-313A-B-SX	N-313A-O-SX	N-313A-N-SX	N-313A-V-SX	N-313A-C-SX	N-313A-L-SX	N-313A-I-SX

art. 314

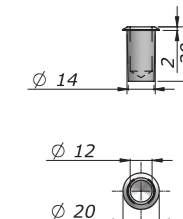

Bussola a pavimento grande  
Big floor bush

argento/silver	bronzo/bronze	oro/gold	nero/black	verniciato/powder	cromato/chrome	oro luc./bright gold	crom.sat/chro. mat
N-0314-A	N-0314-B	N-0314-O	N-0314-N	N-0314-V	N-0314-C	N-0314-L	N-0314-I

legenda / legenda

portata / load	spessori / thickness
-	8 - 12

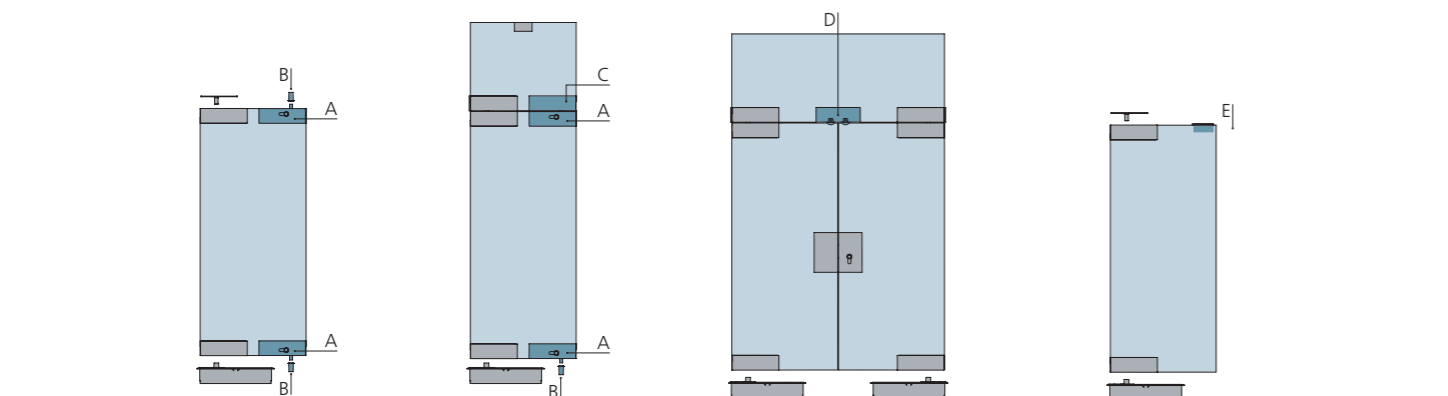

A	B	C	D	E	F	G	H
art. 235	art. 316	art. 236	art. 321	art. 313F	-	-	-

art. 235

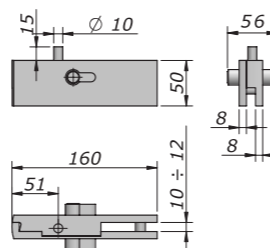
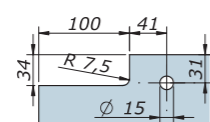

Serratura d'angolo  
Corner lock

argento/silver	bronzo/bronze	oro/gold	nero/black	verniciato/powder	cromato/chrome	oro luc./bright gold	crom.sat/chro. mat
N-0235-A	N-0235-B	N-0235-O	N-0235-N	N-0235-V	N-0235-C	N-0235-L	N-0235-I

art. 236

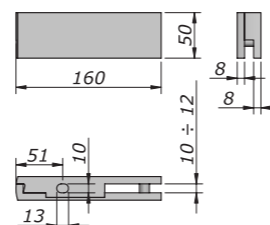
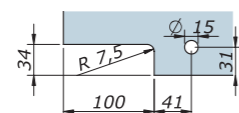

Contro per Art. 235  
Lock keeper for Art. 235

argento/silver	bronzo/bronze	oro/gold	nero/black	verniciato/powder	cromato/chrome	oro luc./bright gold	crom.sat/chro. mat
N-0236-A	N-0236-B	N-0236-O	N-0236-N	N-0236-V	N-0236-C	N-0236-L	N-0236-I

art. 316

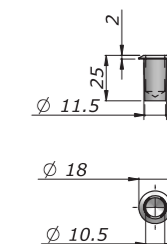

Bussola a pavimento piccola  
Small floor bush

argento/silver	bronzo/bronze	oro/gold	nero/black	verniciato/powder	cromato/chrome	oro luc./bright gold	crom.sat/chro. mat
N-0316-A	N-0316-B	N-0316-O	N-0316-N	N-0316-V	N-0316-C	N-0316-L	N-0316-I

art. 321

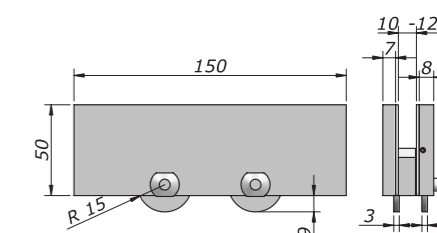
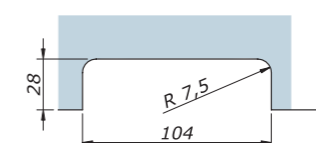

Battuta centrale  
Over panel central patch with stop

argento/silver	bronzo/bronze	oro/gold	nero/black	verniciato/powder	cromato/chrome	oro luc./bright gold	crom.sat/chro. mat
N-0321-A	N-0321-B	N-0321-O	N-0321-N	N-0321-V	N-0321-C	N-0321-L	N-0321-I

art. 313F

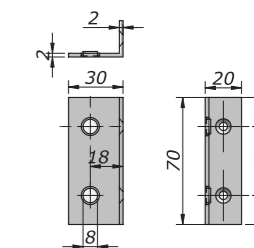

Battuta a 90° fermaporta  
90° Door stop

argento/silver	bronzo/bronze	oro/gold	nero/black	verniciato/powder	cromato/chrome	oro luc./bright gold	crom.sat/chro. mat
N-313F-A	N-313F-B	N-313F-O	N-313F-N	N-313F-V	N-313F-C	N-313F-L	N-313F-I